

3 l  
Art. 867

5 l  
Art. 869

5 l  
Art. 875

5 l  
Art. 879 / 880

**D Betriebsanleitung**  
Drucksprüher

**GB Operating Instructions**  
Pressure Sprayer

**F Mode d'emploi**  
Pulvérisateur à pression préalable / Pulvérisateur

**NL Instructies voor gebruik**  
Drukspuit

**S Bruksanvisning**  
Tryckspruta

**I Istruzioni per l'uso**  
Irroratore a pressione

**E Manual de instrucciones**  
Pulverizador a presión

**P Instruções de utilização**  
Pulverizador de Pressão

**DK Brugsanvisning**  
Trykspøjtte

# GARDENA Pressure Sprayer

Welcome to the garden of GARDENA...



Translation of the original instructions from German. Please read these operating instructions carefully and observe the notes given. Use these operating instructions to familiarise yourself with the Pressure Sprayer, its proper use and the notes on safety.



For safety reasons, children and young people under 16 as well as anyone not familiar with these operating instructions should not use the Pressure Sprayer.

→ Please keep these operating instructions in a safe place.

## Contents

1. Where to Use Your GARDENA Pressure Sprayer .....	10
2. For Your Safety .....	11
3. Assembly .....	12
4. Operation .....	13
5. Cleaning .....	15
6. Trouble-Shooting .....	15
7. Storage .....	16
8. Accessories .....	16
9. Technical data .....	16
10. Service .....	16

## 1. Where to Use Your GARDENA Pressure Sprayer

### Intended purpose

The GARDENA Pressure Sprayer is intended for distributing solvent-free liquid pesticides<sup>1)</sup>, herbicides<sup>1)</sup>, fertilisers<sup>1)</sup>, window cleaners<sup>1)</sup>, and car wax<sup>1)</sup> in domestic gardens and allotments.

It must not be used in public places, parks, sport arenas, or in agriculture or forestry.

Compliance with the operating instructions provided by the manufacturer is a prerequisite for using the Pressure Sprayer correctly.

1) In accordance with the laws governing the use of pesticides and detergents, only authorised substances may be used (authorised specialist shop).

### Caution!



**Due to the risk of physical injury, the GARDENA Pressure Sprayer must not be used for spraying substances other than those specified by GARDENA. Do not use your Pressure Sprayer for spraying acids, disinfectants or water-proofing agents.**

We recommend that you only use pesticides approved by the BBA (German Federal Biological Research Centre for Agriculture and Forestry). To our knowledge at the time of manufacturing the unit, the pesticides approved by the BBA will not damage the materials used to construct the Pressure Sprayer.

When spraying insecticides, herbicides and fungicides or other liquid plant protection products, you must comply with all special precautionary measures specified by the manufacturer of the product you are using.

## 2. For Your Safety

### *Danger of physical injuries:*



- Never open the Pressure Sprayer or unscrew the nozzle when the Pressure Sprayer is still pressurised.
- To prevent injury, never connect the Pressure Sprayer to an air-compressor.
- Before pulling out the safety valve, the sprayer always has to be placed vertically.
- Before opening the sprayer, always release pressure completely by pulling out the safety valve.

### *Cleaning:*



- Release the pressure after each use (ensuring that the Pressure Sprayer is always vertical), empty the container, clean it carefully and rinse with clear water. Then leave the pressure sprayer open and allow it to dry.

Do not dispose of residual fluids in the sewerage system (→ local disposal systems).

- Always clean the Pressure Sprayer before using a different product to avoid chemical reactions.

For cleaning the valves, the spray pipe and nozzle, operate the unit with clear water (if necessary, by adding some washing-up liquid).

- To prevent reactions with the products you are using, never use aggressive cleaning agents that contain solvent or petrol.
- When there is dirt on the container cap or the container, clean the container carefully around the thread and the thread O-ring.

Take care not to mix up the tanks and tank caps if you are using several Pressure Sprayers at the same time.

### *Operation:*

- Inspect the Pressure Sprayer visually before each use. Never leave your Pressure Sprayer unattended or for long periods when full and pressurised.

- Keep the unit out of the reach of children.

You are responsible for the safety of others.

- Operate the safety valve only when the sprayer is placed vertically.
- Keep your Pressure Sprayer away from heat sources and hot environments.

We recommend that you have your Pressure Sprayer thoroughly inspected (preferably at a GARDENA Service Centre) after using it for 5 years.

### *Storage:*

Before storing, loosen the tank cap and always empty your Pressure Sprayer completely (also after cleaning with water). Store away from frost.

- If you use the permanent lock pay attention that you work very carefully. Never store your pressure sprayer with permanent lock.

## 3. Assembly

### 3.1. General Assembly Instructions for all Pressure Sprayers (Art. No. 867/869/875/879/880)

#### Mounting the spray tube in the hand valve:

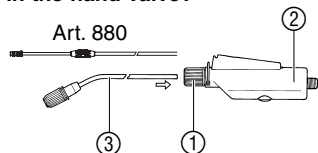

1. Unscrew the union nut ① on the hand valve ②.
2. Push the spray tube ③ all the way into the hand valve ②.
3. Tighten the union nut ① on the hand valve ② by hand (do not use pliers).

The sprayer tube of art. 880 is telescopic (min. / max. sprayer tube length 60 / 100 mm).

#### Attaching the spray hose to the hand valve:

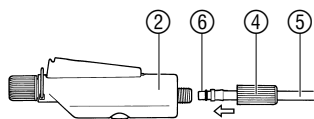

1. Push the long union nut ④ over the spray hose ⑤.
2. Push the spray hose ⑤ with connection nipple ⑥ into the hand valve ②.
3. Tighten the long union nut ④ on the hand valve ② by hand (do not use pliers).

### 3.2. Assembly Instructions for Pressure Sprayer Art. No. 869

#### Installing the filter and suction pipe:

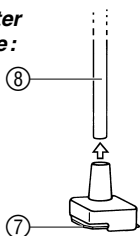

1. Shut the filter ⑦ and press firmly into the suction pipe ⑧.
2. Guide the suction pipe ⑧ through the eyelet at the pump tube ⑨ and press firmly into the opening in the container cap.

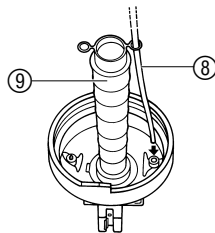

#### Attaching the spray hose to the container cap:

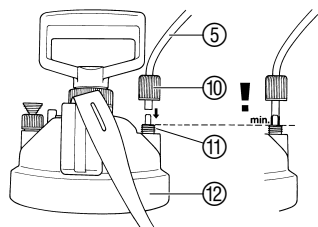

1. Push the short union nut ⑩ over the spray hose ⑤.
2. Push on the spray hose ⑤ so that it covers at least the beginning of the thread ⑪.
3. Screw the short union nut ⑩ onto the container cap ⑫ and tighten by hand (do not use pliers).

#### Attaching the shoulder strap:

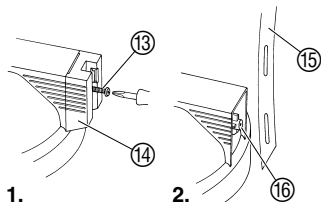

1. Unscrew the screw ⑬ using a screwdriver and remove the spray tube holder ⑭.
2. Put the shoulder strap ⑮ with the elongated hole over the plastic tube ⑯.
3. Reattach the spray tube holder ⑭ and screw in the screw ⑬ using a screwdriver.

### 3.3. Assembly Instructions for Pressure Sprayer Art. No. 875 / 879 / 880

#### Attaching the spray hose to the container cap:

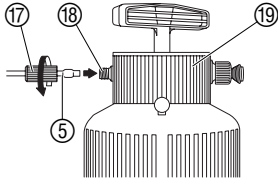

1. Push the short union nut ⑰ over the spray hose ⑤.
2. Push on the spray hose ⑤ so that it covers at least the beginning of the thread ⑱.
3. Screw the short union nut ⑰ onto the container cap ⑲ and tighten by hand (do not use pliers).

#### Attaching the shoulder strap:

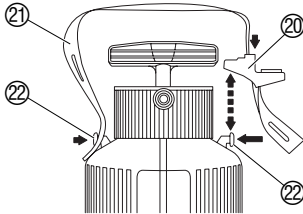

1. Remove the spray tube holder ⑳ from above (direction of the arrow).
2. Guide the shoulder strap ㉑ through the elongated hole of the spray tube holder ⑳ and attach it into the holder ㉒ of the container.
3. Press the spray tube holder back on until you hear it click into place.
4. Attach the shoulder strap on the other side of the holder ㉒.

## 4. Operation

### 4.1. Operating Instructions for Pressure Sprayer Art. No. 867 / 869

#### Filling the container:

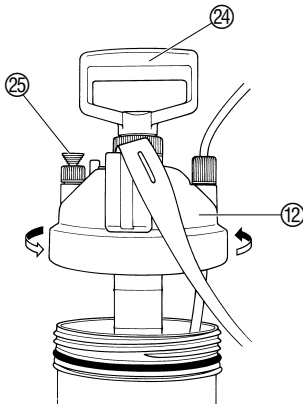

1. Mix the fluid well.
2. Unscrew the container cap ⑫.
3. Pour the fluid into the container up to the maximum mark (3 litres or 5 litres).  
*Please observe the safety and proportioning instructions provided by the manufacturer of the product you are going to spray.*
4. Screw the container cap ⑫ back on and tighten by hand (do not use pliers).



#### Risk of injury!

→ **Never connect your Pressure Sprayer to an air compressor.**

5. Pull the pump lever ㉔ repeatedly (approx. 30 to 40 times) until the operating pressure has been reached.  
*Any excess pressure escapes through the safety valve ㉕.*

## 4.2. Operating Instructions for Pressure Sprayer Art. No. 875/879/880

### Filling the container:

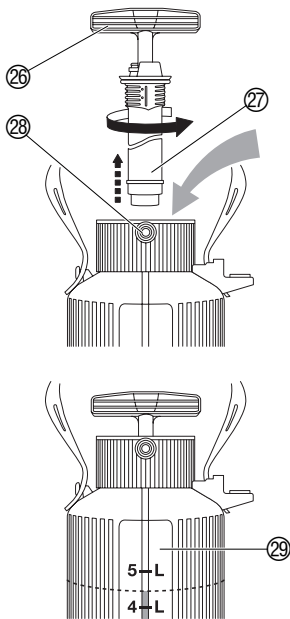

1. Mix the fluid well.
2. Press the pump handle ②⑥ down slightly, turn to the left and remove the pump ②⑦.
3. Pour the fluid into the container up to the maximum mark (5 litres).  
*Please observe the safety and proportioning instructions provided by the manufacturer of the product you are going to spray.*
4. Tighten the pump again with the pump handle ②⑥ by hand (do not use pliers).



### Risk of injury!

→ **Never connect your Pressure Sprayer to an air compressor.**

5. Unlock the pump handle ②⑥ by turning slightly to the left and pump the pump repeatedly (approx. 30 - 40 times) until the operating pressure is reached.  
*Any excess pressure escapes through the safety valve ②⑧.*

The Pressure Sprayer Art. No. 879/880 features a window with a scale ②⑨ to help you measure out the appropriate dosage of fertilisers. The window also allows you to see how much fluid is left in the container.

## 4.3. General Operating Instructions for all Pressure Sprayers (Art. No. 867/869/875/879/880)

### Spraying:

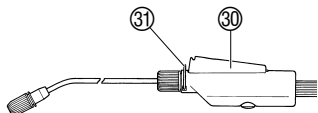

1. Press the operating switch ③⑩ on the handle.  
*The Pressure Sprayer begins spraying.*
2. Release the operating switch ③⑩ on the handle.  
*The Pressure Sprayer stops spraying.*

Setting the permanent lock:

→ Press the permanent lock ③⑪.

*The operating switch ③⑩ is pressed down and stays down.*

### Adjusting the spray tube:

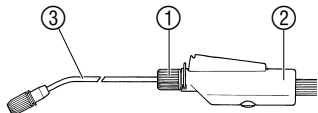

The spray tube can be swivelled 360° in the hand valve.

1. Unscrew the union nut ① on the hand valve ②.
2. Turn the spray tube ③ to the correct position.
3. Tighten the union nut ① on the hand valve ② by hand (do not use pliers).

### Setting the spray jet:

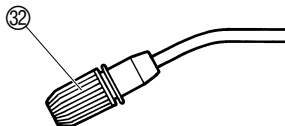

You can adjust the spray jet from full jet (nozzle closed) to a fine mist spray (nozzle open).

→ Open or close the spray nozzle ③⑫ according to the spray jet you require.

## 5. Cleaning

### Cleaning the Pressure Sprayer:

Always clean your Pressure Sprayer after spraying.

→ Fill the Pressure Sprayer with clean water (the water may contain some washing-up liquid if necessary) and empty out the water by spraying it through the spray tube in the same way as when spraying a product.

*This cleans the valves, the spray tube and the nozzles.*

We recommend that you have your Pressure Sprayer thoroughly inspected (preferably at a GARDENA Service Centre) after using it for 5 years.

## 6. Trouble-Shooting

### Cleaning the filter:

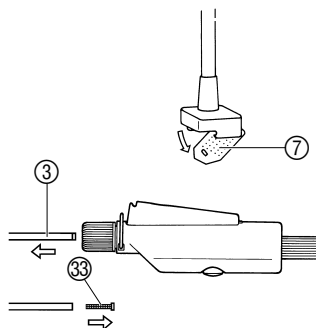

If the spray jet from the Pressure Sprayer is very weak you should clean the filter in the container.

### Pressure Sprayer Art. No. 867/869

1. Unscrew the container cap.
2. Flip up the filter ⑦ and rinse under running water.
3. Close the filter ⑦ and screw the container cap back on.

### Pressure Sprayer Art. No. 875/879/880

Remove the filter ③③ from the spray tube ③ and clean it.

Problem	Possible Cause	Remedy
<b>Pump does not build up pressure.</b>	Container cap is not airtight.	→ Fasten the container cap as tight as it will go (Art. 867/869).
	Safety valve is loose.	→ Tighten the safety valve.
	Hose connection at the container and hand valve is not tight.	→ Tighten the hose connections at the container and hand valve.
	Continuous lock enabled on handle.	→ Take off the permanent lock at the hand valve.
<b>Pressure Sprayer does not spray although there is sufficient pressure or only sprays with a weak spray jet.</b>	Nozzle is blocked.	→ Clean the nozzle.
	Filter is blocked.	→ Clean the filter in the container (Art. 867/869). Clean the filter in the spray tube (Art. 875/879/880).
<b>It is difficult to open and close the container.</b>	Container pressure too high.	→ Release the container pressure completely by means of the safety valve. Grease the container O-ring with acid-free grease (Art. 867/869).

If you have any other problems with your Pressure Sprayer please contact GARDENA Customer Service.

## 7. Storage

---

### **Storing your Pressure Sprayer:**

1. Clean the Pressure Sprayer (refer to 5. Cleaning).
2. Keep your Pressure Sprayer in a place protected from frost.

## 8. Accessories

---

<b>GARDENA Weedkiller Cone</b>	Prevents spray mist from blowing away.	<b>Art. No. 894</b>
<b>GARDENA Extension Lance</b>	For extending the spray tube.	<b>Art. No. 897</b>
<b>GARDENA Telescopic Tube</b>	Telescopic extension for the spray tube	<b>Art. No. 899</b>

## 9. Technical data

---

	<b>Art. No. 867</b>	<b>Art. No. 869 / 875 / 879</b>	<b>Art. No. 880</b>
<b>Max. capacity</b>	3 l (5 pints approx.)	5 l (8 pints approx.)	5 l (8 pints approx.)
<b>Spray tube length</b>	36 cm	36 cm	60/100 cm
<b>Hose length</b>	150 cm	150 cm	150 cm
<b>Permissible working pressure</b>	3 bar	3 bar	3 bar
<b>Permissible operating temperature</b>	40 °C	40 °C	40 °C

## 10. Service

---

### **Warranty**

GARDENA guarantees this product for 2 years (from date of purchase). This guarantee covers all serious defects of the unit that can be proved to be material or manufacturing faults. Under warranty we will either replace the unit or repair it free of charge if the following conditions apply:

- The unit must have been handled properly and in keeping with the requirements of the operating instructions.
- Neither the purchaser or a non-authorised third party have attempted to repair the unit.

This manufacturer's guarantee does not affect the user's existing warranty claims against the dealer/seller.

If you have any problems with your Pressure Sprayer, please contact our Customer Service or return the defective unit together with a short description of the problem directly to one of the GARDENA Service Centres listed on the back of this leaflet.

### **Product Liability**

We expressly point out that, in accordance with the product liability law, we are not liable for any damage caused by our units if it is due to improper repair or if parts exchanged are not original GARDENA parts or parts approved by us, and, if the repairs were not carried out by a GARDENA Service Centre or an authorised specialist. The same applies to spare parts and accessories.



**Deutschland / Germany**

GARDENA  
Manufacturing GmbH  
Service Center  
Hans-Lorenser-Straße 40  
D-89079 Ulm  
Produktfragen:  
(+49) 731 490-123  
Reparaturen:  
(+49) 731 490-290  
service@gardena.com

**Argentina**

Argensem® S.A.  
Calle Colonia Japonesa s/n  
(1625) Loma Verde  
Escobar, Buenos Aires  
Phone: (+54) 34 88 49 40 40  
info@argensem.com.ar

**Australia**

Nylex Consumer Products  
50-70 Stanley Drive  
Somerton, Victoria, 3062  
Phone: (+61) 1800 658 276  
spare.parts@nylex.com.au

**Austria / Österreich**

GARDENA  
Österreich Ges.m.b.H.  
Stettnerweg 11-15  
2100 Korneuburg  
Tel.: (+43) 22 62 7 45 45 36  
kundendienst@gardena.at

**Belgium**

GARDENA Belgium NV/SA  
Sterrebeekstraat 163  
1930 Zaventem  
Phone: (+32) 2 7 20 92 12  
Mail: info@gardena.be

**Brazil**

Palash Comércio e  
Importação Ltda.  
Rua Américo Brasiliense,  
2414 - Chácara Sto Antonio  
São Paulo - SP - Brasil -  
CEP 04715-005  
Phone: (+55) 11 5181-0909  
eduardo@palash.com.br

**Bulgaria**

DENEX LTD.  
2 Luis Ahalier Str. - 7th floor  
Sofia 1404  
Phone: (+359) 2 958 18 21  
office@denex-bg.com

**Canada**

GARDENA Canada Ltd.  
100 Summerlea Road  
Brampton, Ontario L6T 4X3  
Phone: (+1) 905 792 93 30  
info@gardenacanada.com

**Chile**

Antonio Martinic y Cia Ltda.  
Cassillas 272  
Centro de Cassillas  
Santiago de Chile  
Phone: (+56) 2 20 10 708  
garfar\_cl@yahoo.com

**Costa Rica**

Compania Exim  
Euroberoamericana S.A.  
Los Colegios, Moravia,  
200 metros al Sur del Colegio  
Saint Francis - San José  
Phone: (+506) 297 68 83  
exim\_euro@racsa.co.cr

**Croatia**

KLIS d.o.o.  
Stanciceva 79  
10419 Vukovina  
Phone: (+385) 1 622 777 0  
gardena@klis-trgovina.hr

**Cyprus**

FARMOKIPIKI LTD  
P.O. Box 7098  
74, Digeni Akritra Ave.  
1641 Nicosia  
Phone: (+357) 22 75 47 62  
condam@spidernet.com.cy

**Czech Republic**

GARDENA spol. s r.o.  
Řípská 20a, č.p. 1153  
627 00 Brno  
Phone: (+420) 800 100 425  
gardena@gardenabrn.cz

**Denmark**

GARDENA Norden AB  
Salgsafdeling Danmark  
Box 9003  
S-200 39 Malmö  
info@gardena.dk

**Finland**

Habitec Oy  
Martinkyläntie 52  
01720 Vantaa

**France**

GARDENA  
PARIS NORD 2  
69, rue de la Belle Etoile  
BP 57080  
ROISSY EN FRANCE  
95948 ROISSY CDG CEDEX  
Tél. (+33) 0826 101 455  
service.consommateurs@  
gardena.fr

**Great Britain**

GARDENA UK Ltd.  
27-28 Brenkley Way  
Bleazard Business Park  
Seaton Burn  
Newcastle upon Tyne  
NE13 6DS  
info@gardena.co.uk

**Greece**

Agrokrip  
Psomadopoulos S.A.  
Ifaistou 33A  
Industrial Area Koropi  
194 00 Athens Greece  
V.A.T. EL093474846  
Phone: (+30) 210 66 20 225  
service@agrokrip.gr

**Hungary**

GARDENA  
Magyarország Kft.  
Késmárk utca 22  
1158 Budapest  
Phone: (+36) 80 20 40 33  
gardena@gardena.hu

**Iceland**

Ó. Johnson & Kaaber  
Tunguhalsi 1  
110 Reykjavik  
oaj@ojk.is

**Ireland**

Michael McLoughlin & Sons  
Hardware Limited  
Long Mile Road  
Dublin 12

**Italy**

GARDENA Italia S.p.A.  
Via Donizetti 22  
20020 Lainate (Mi)  
Phone: (+39) 02.93.94.79.1  
info@gardenaitalia.it

**Japan**

KAKUICHI Co. Ltd.  
Sumitomo Realty &  
Development Kojimachi  
BLDG., 8F  
5-1 Nibannayo, Chiyoda-ku  
Tokyo 102-0084  
Phone: (+81) 33 264 4721  
m\_ishihara@kaku-ichi.co.jp

**Luxembourg**

Magasins Jules Neuberg  
39, rue Jacques Stas  
Luxembourg-Gasperich 2549  
Case Postale No. 12  
Luxembourg 2010  
Phone: (+352) 40 14 01  
api@neuberg.lu

**Netherlands**

GARDENA Nederland B.V.  
Postbus 50176  
1305 AD ALMERE  
Phone: (+31) 36 521 00 00  
info@gardena.nl

**Neth. Antilles**

Jonka Enterprises N.V.  
Sta. Rosa Weg 196  
P.O. Box 8200, Curaçao  
Phone: (+599) 9 767 66 55  
pgm@jonka.com

**New Zealand**

NYLEX New Zealand Limited  
Building 2, 118 Savill Drive  
Mangere, Auckland  
Phone: (+64) 0800 22 00 88  
spare.parts@nylex.com.au

**Norway**

GARDENA Norden AB  
Salgskontor Norge  
Karihaugveien 89  
1086 Oslo  
info@gardena.no

**Poland**

GARDENA Polska Sp. z o.o.  
Szymanów 9 d  
05-532 Baniocha  
Phone: (+48) 22 727 56 90  
gardena@gardena.pl

**Portugal**

GARDENA Portugal Lda.  
Recta da Granja do Marquês  
Edif. GARDENA Algueirão  
2725-596 Mem Martins  
Phone: (+351) 21 922 85 30  
info@gardena.pt

**Romania**

MADEX INTERNATIONAL SRL  
Soseaua Odaii 117-123,  
Sector 1,  
București, RO 013603  
Phone: (+40) 21 352 76 03  
madex@ines.ro

**Russia / Россия**

ООО ГАРДЕНА РУС  
123007, г. Москва  
Хорошевское шоссе, д. 32А  
Тел.: (+7) 495 647 25 10  
info@gardena-rus.ru

**Singapore**

Hy - Ray PRIVATE LIMITED  
40 Jalan Pemimpin  
#02-08 Tat Ann Building  
Singapore 577185  
Phone: (+65) 6253 2277  
hyray@singnet.com.sg

**Slovak Republic**

GARDENA Slovensko, s.r.o.  
Panónska cesta 17  
851 04 Bratislava  
Phone: (+421) 263 453 722  
info@gardena.sk

**Slovenia**

GARDENA d.o.o.  
Brodišče 15  
1236 Trzin  
Phone: (+386) 1 580 93 32  
servis@gardena.si

**South Africa**

GARDENA  
South Africa (Pty.) Ltd.  
P.O. Box 11534  
Vorna Valley 1686  
Phone: (+27) 11 315 02 23  
sales@gardena.co.za

**Spain**

GARDENA IBÉRICA S.L.U.  
C/ Basauri, nº 6  
La Florida  
28023 Madrid  
Phone: (+34) 91 708 05 00  
atencioncliente@gardena.es

**Sweden**

GARDENA Norden AB  
Försäljningskontor Sverige  
Box 9003  
200 39 Malmö  
info@gardena.se

**Switzerland / Schweiz**

GARDENA (Schweiz) AG  
Bitzberg 1  
8184 Bachenbülach  
Phone: (+41) 848 800 464  
info@gardena.ch

**Turkey**

GARDENA / Dost Diş Ticaret  
Müessesilik A.Ş. Sanayi  
Çad. Adil Sokak No. 1  
Kartal - İstanbul  
Phone: (+90) 216 38 93 939  
info@gardena-dost.com.tr

**Ukraine / Украина**

ALTESTEST JSC  
4 Petropavlivska Street  
Petropavlivska  
Borschahivka Town  
Kyivo Svyatoslyn Region  
08130, Ukraine  
Phone: (+380) 44 459 57 03  
upryr@altsest.kiev.ua

**USA**

Melnor Inc.  
3085 Shawnee Drive  
Winchester, VA 22604  
Phone: (+1) 540 722-9080  
service\_us@melnor.com

879-20.960.06 / 0607

© GARDENA  
Manufacturing GmbH  
D-89070 Ulm  
http://www.gardena.com