

Assembly Instructions
-----------------------

**A 13 Amp fuse must be fitted to the Mains Plug.** The normal plug fuse and household fuse only protect the electrical equipment and are not a safeguard against

**No earth required.** Flymo products are double insulated to EN60335 and under no circumstances should an earth be connected to any part of the product.

\_\_\_\_\_ **S**

## S

2

Assembly

specifications: Ordinary rubber (60245 IEC 53), Ordinary PVC (60227 IEC 53) or Ordinary PCP (60245 IEC 57)

**YOUR PRODUCT IS SUPPLIED WITH AN ELECTRIC MAINS CABLE WIRED DIRECTLY INTO THE PRODUCT.**

С

100

 Wheel

Carton Contents

---

1

**Failures not covered by guarantee**  
\* Replacing Nylon Line

## Part no.: 51

Part no.: 513937190  
Part no.: 510245990

considered when disposing By ensuring this product potential negative conse

- By ensuring this product is disposed of correctly, you will help prevent potential negative consequences for the environment and human health, which could otherwise be caused by inappropriate waste handling of this product.
- For more detailed information about recycling of this product, please contact your local council office, your household waste disposal service or the shop where you purchased the product.

contact your local council office, your household waste disposal service or the shop where you purchased the product.

	<b>CTE25</b>
--	--------------

Husqvarna AB  
S-561 82 Huskvarna

 **Original text**

---

---



100



Assembly Instructions cont'

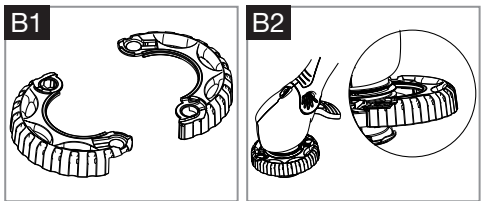

**Wheel assembly (B1) & (B2)**  
1. Attach the wheel to the trimmer making sure that it is located into the **BOTTOM** groove on the trimmer head as illustrated in **fig. B1**.  
2. Clip the wheel together on each side making sure it is secure. (**B2**).  
3. The wheel should turn freely.

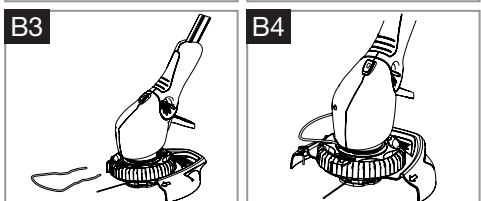

**Plant Guard Assembly (B3) & (B4)**  
1. Open the plant guard as illustrated in **fig. B3** and place into the **TOP** groove on the trimmer head. Rotate the plant guard clockwise until it **CLICKS** into its parked position (**B4**).

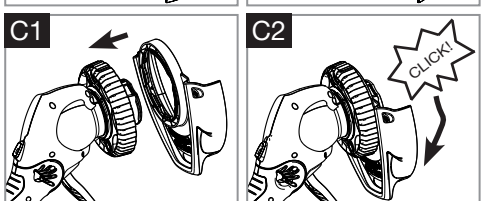

**Safety Guard Assembly (C1) & (C2)**  
1. Locate the safety guard over the cutting head. Ensure the nylon line is fed through the hole in the safety guard as illustrated in **fig. C1**.  
2. Push into location and turn safety guard in the direction illustrated in **fig. C2**, until a click is heard and the safety guard is securely locked in position.  
• **ENSURE THE SAFETY GUARD IS SECURELY IN PLACE BY ATTEMPTING TO TWIST GUARD.**

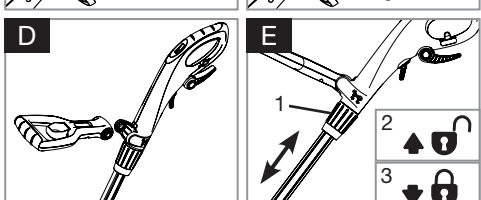

**Steady Handle Assembly (D)**  
1. Pull the steady handle release lever towards the handle grip.  
2. Depress the two buttons on the side of the steady handle.  
3. Locate the buttons into the main handle and release the lever.  
4. Adjust the steady handle to the most comfortable operating position by pulling the release lever and moving the handle.

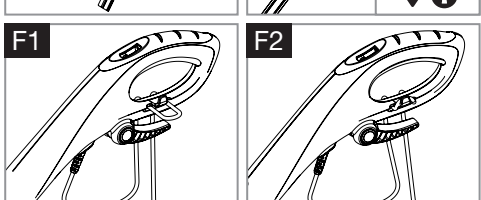

**Height Adjustment (E)**  
1. Turn height adjuster (**E1**) in the direction indicated to un-lock (**E2**).  
2. Adjust the length of the tube to the most comfortable operating position.  
3. Turn height adjuster in the opposite direction to lock (**E3**).  
• **ENSURE THAT THE TUBE IS FULLY SECURED.**

**Cable Restraint (F1) & (F2) (optional)**  
1. Form loop in mains cable and push the loop through the slot as illustrated in picture (**F1**).  
2. To secure, position loop over the hook and pull the cable back through the slot as illustrated in picture (**F2**).

Double Auto Feed System

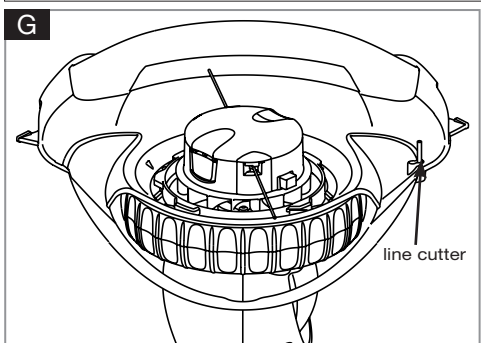

**How the automatic line feed works (G)**  
1. When initially switching on the trimmer, a small length of line is fed out.  
2. A 'clattering' noise will be heard when the two nylon lines hit the line cutter. **DO NOT BE ALARMED this is quite normal.** After approximately 5 seconds the line will be cut to the correct length and the noise will reduce as the motor reaches full speed.  
• **Make sure the motor is up to full speed before trimming or edging.**  
3. If the noise of the nylon line being cut cannot be heard, more line will need to be fed out.  
4. To feed more line, it is first necessary to allow the motor to stop completely, then re-start, allowing the motor to reach full speed.  
5. Repeat step 4. until you hear the lines hitting against the cutter. (Do not repeat this procedure more than 6 times)  
6. If problems are experienced with the automatic line feed refer to Fault Finding Chart.

How to use

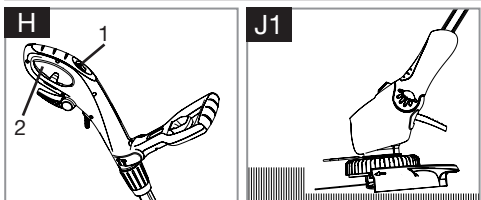

• **WARNING**  
• **The use of eye protection is recommended.**  
**Do not lean over the trimmer whilst trimming or edging, objects may be thrown by the cutting line.**  
**Do not allow cutting head to rest on the ground.**  
**Do not overload your trimmer.**  
Overloading can be avoided by making sure the motor speed does not drop unduly.  
**Disconnect from the mains electricity supply before attempting any maintenance or adjustment.**  
• **BEFORE USE**  
• **Make sure that both lines are fed out.**  
• **Make sure motor is up to full speed before trimming or edging.**

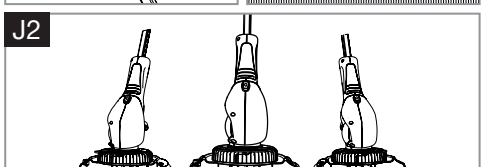

**How to trim**  
PRODUCTS 580E & 650E CONTAIN AN AUTOMATIC ELECTRONIC SENSOR WHICH INCREASE THE SPEED OF THE MOTOR AS THE LOAD INCREASES (i.e. CUTTING GRASS).  
UNDER LIGHTER LOAD CONDITIONS OR NO LOAD THE SPEED DECREASES AUTOMATICALLY.  
THIS WILL OPTIMISE THE CUTTING SPEED IN ALL CONDITIONS AND ENSURES THE CORRECT SPEED FOR EACH TYPE OF GRASS.  
1. Hold as illustrated in **fig. H**.  
2. To start, squeeze the safety lock off (**H1**) and then the switch lever (**H2**).  
3. Cut with nylon line at an angle using the tip. See **fig. J1**.  
4. Swing trimmer in and out of the cutting area taking small cuts (**J2**).  
5. Line is fed out automatically every time the trimmer head stops rotating and returns to operating speed.  
• Extra line can be fed out manually as described in Manual line feed  
6. To stop your trimmer release the switch lever.

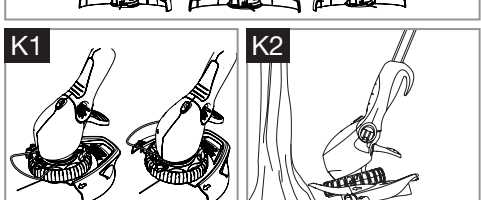

**Using the Plant & Tree Guard**  
The Plant and Tree guard allows the trimming of grass close to plants and trees without damaging them with the cutting line.  
1. Rotate the guard into it's forward position as illustrated in **K1**.  
2. Uste the trimmer around trees (**K2**) and near plants.

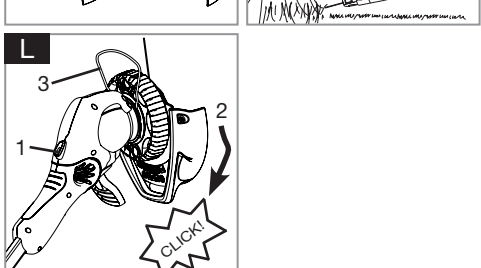

**How to edge**  
1. Ensure the plant guard is in the **PARK** position.  
2. To convert to edging mode, press button (**L1**) and twist head (**L2**). An audible "click" will confirm that the head is locked.  
3. Hold as illustrated in **Fig H**.  
4. To start, squeeze the safety lock-off (**H1**) and then the switch lever (**H2**).  
5. Rest edger on wheel for extra stability and line up the edge of the lawn. Edge in direction indicated in **Fig M**.  
6. To stop your trimmer release the switch lever.  
7. To return to trimming mode, press button and twist head back the opposite way. An audible "click" will confirm that the head is locked.  
• **When edging, ensure that the edging wheel is always resting on the grass (and not on the path/driveway).**

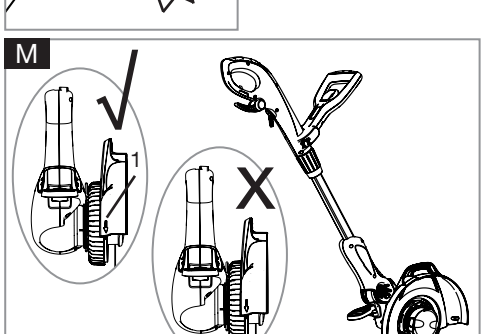

**Using the Shrugging position**  
1. By pressing the lever (**N1**) with your foot, the handle can be lowered into three different positions to enable the use of the product under shrubs and low obstacles (**P**).

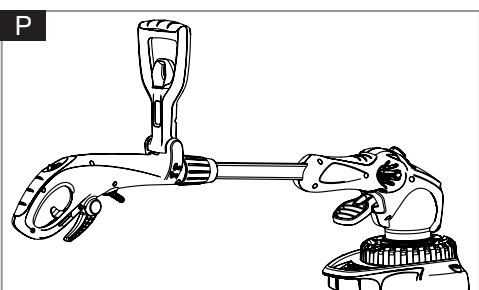
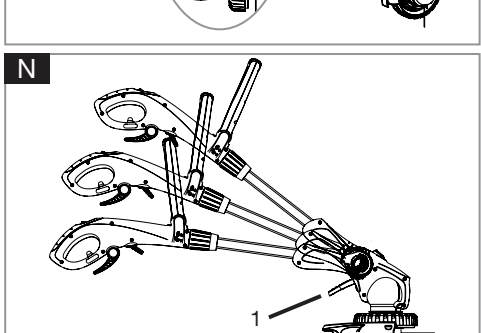

Manual line feed

**To manually feed the nylon line (Q)**  
1. If required line can be fed out manually.  
2. To operate, press and release manual line feed button, whilst gently pulling on one of the lines until the line reaches the line cutter.  
3. When the required amount of line is fed out, gently pull on the second line (there is no need to press the manual line feed button again).  
4. If the line extends past the line cutter, too much line has been fed out.  
5. If too much line is fed out, remove the spool cap and click spool anti-clockwise until the line is at the desired length.  
• **Always return the product to its normal operating position before switching on.**

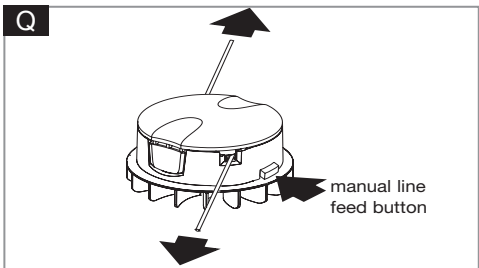

Cutting Head

**To remove spool cap**  
1. Press and hold in the two cap release latches. (**R**).  
2. Pull cap away from the spoolholder. (**R**).  
**When refitting the spool cap**  
1. Keep all areas of the cap and spoolholder clean. Failure to do so may prevent the cap being securely located in the spoolholder.  
2. Replace the cap, **pressing firmly DOWN** towards the spoolholder to ensure cap is fully located.  
3. Check that the cap is correctly fitted by trying to remove it without depressing the two latches.  
**To replace nylon line.**  
For your convenience it is recommended you buy spool and line complete. Nylon line only is also available. Both are available from Husqvarna Australia PTY// Husqvarna New Zealand Ltd. stockists.  
**To fit spool and line complete:**  
1. Remove the cap.  
2. Remove old spool.  
3. Place spool into spoolholder.  
4. Release one line from cleat (**T1**).  
5. Secure line into slot (**S1**).  
6. Repeat for second line.  
• **Ensure spool is fully located by gently rotating it during fitment, whilst keeping the spoolholder steady.**  
7. Refit the cap.  
**To fit nylon line only:**  
• Remember! Your Flymo Trimmer 500 E is designed to use only nylon line with a **diameter of 1.5 mm**, Trimmer 580 E and 650 E are designed to use nylon line with a **diameter of 2.0 mm**.  
Use only genuine Flymo nylon line.  
**1. IMPORTANT - Always wind the line onto the upper section of the spool first.**  
Take approximately 5 metres of line. Insert 15 mm of line into one of the holes in the upper section of the spool (**T**) and wind line in the direction of the arrows on the top of the spool. Leave approximately 100mm of line unwound and place into cleat as illustrated in figure **T1**. Repeat on lower section of spool.  
2. Care should be taken to ensure that the line is neatly coiled on the spool. Failure to do so will impair the efficiency of the automatic line feed.  
3. Then fit spool as described in 'To fit spool and line complete', section above.  
**Always return the product to its normal operating position before switching on.**

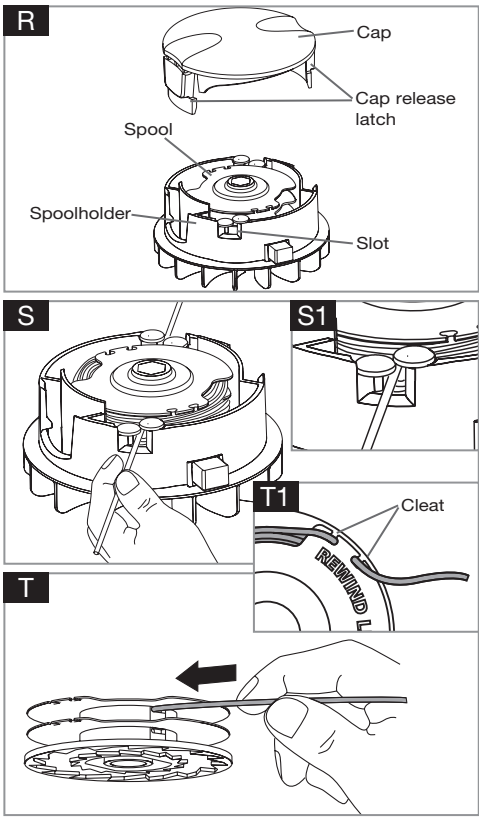

Maintenance

• **WARNING**  
**Disconnect from the mains electricity supply, before attempting any maintenance or adjustment. Cutting head continues to rotate after the trimmer has been switched off. Keep fingers and hands clear of the line cutter on leading edge of guard.**

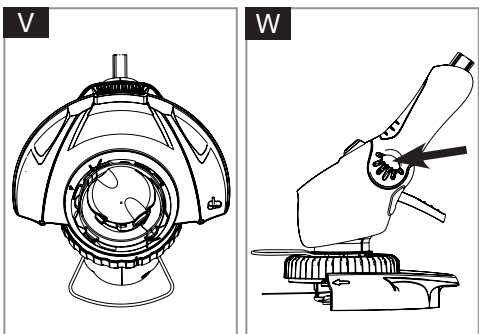

**Caring for your product**  
After you have finished using your product follow the procedure below:  
**AVOID ACCIDENTAL STARTING. REMOVE PLUG FROM MAINS AND KEEP FEET AWAY FROM THE SWITCH LEVER WHEN: CLEANING AROUND THE INSIDE OF THE SAFETY GUARD, REMOVING OR REFITTING SPOOL CAP, MANUALLY FEEDING OR REPLACING NYLON LINE.**  
1. Disconnect from the mains electricity supply.  
2. Never clean your trimmer with water, cleaning fluids, or solvents, just remove debris with a suitable tool, a soft brush or dry cloth.  
3. Using a soft brush, clean around the inside of the safety guard, the cutting head (**V**) and the motor housing air vents. (**W**).  
4. Remove the wheel by pressing one of the buttons. Clean the wheel and groove on trimmer head with a soft brush (**X** & **Y**).  
5. Attach wheel as described in Wheel Assembly.  
6. Inspect the trimmer carefully, especially the parts of the cutting head.  
7. If your trimmer is damaged in any way contact your local approved service centre.  
• **Never use a damaged trimmer.**  
8. Store in a cool, dry place and out of reach of children.

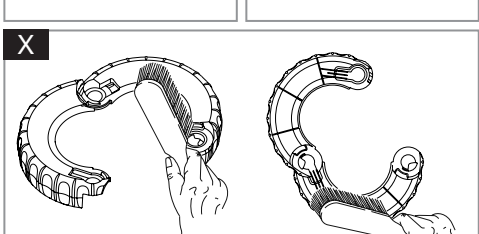

**Cable Storage**  
1. Your mains cable can be stored on the product as illustrated in **fig. Z1**.  
2. Wind cable carefully to avoid kinking.  
3. To release the cable press the button and the hook will drop down (**Z2**).  
4. Push cable hook fully back into position.

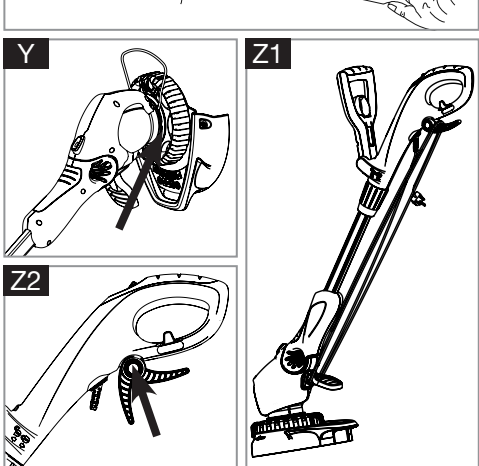

Fault Finding Chart

WARNING Disconnect from the mains electricity supply before attempting any maintenance or adjustment.			
FAULT	CHECK		ACTION
LINE NOT FEEDING OR LINE TOO SHORT OR TRIMMER VIBRATES	Is the automatic line feed working?	No	Manually feed out line. SEE "MANUAL LINE FEED"
	Is the line fed out and visible? Has line been removed from cleat?	No	Remove cap and spool, free line and re-fit spool and cap. SEE "CUTTING HEAD"
	Is the manual line feed working?	No	The line may be jammed on the spool. Rewind line to remove crossed loops. Check that line is in correct section of spool.
CONTINUOUS CLATTERING NOISE	Has the motor reached full speed before use?	No	Allow the motor to reach full speed before use.
	Has too much line been fed out?	Yes	SEE "MANUAL LINE FEED"
	Is the line cutter missing from the safety guard?	Yes	Contact your local approved Service Centre.
LINE SNAPS CONTINUOUSLY	Are you using the trimmer correctly?	?	Only use tip of nylon line to trim. SEE "How to trim and edge".
	Is the line jamming on the spool?	Yes	Rewind the line on the spool, if symptoms still persist, change spool and line.
WHEEL STOPS TURNING	Clean wheel and groove on trimmer head.		SEE "MAINTENANCE"
IF NONE OF THE ABOVE OR IF FAULT PERSISTS	Contact Husqvarna Australia PTY. Ltd, Customer Service Department direct, Telephone: 024352 7400 Husqvarna New Zealand Ltd., Customer Service Department direct, Telephone: 9920 2410		