



115 49 36 38 (208)

GB

## OWNER'S MANUAL

### DUSTER



# MD6210

Original Language

#### **WARNING**

- Before using our products, please read this manual carefully to understand the proper use of your unit.
- Keep this manual handy.

**▲ SAFETY FIRST**

Instructions contained in warnings within this manual marked with a ▲ symbol concern critical points which must be taken into consideration to prevent possible serious bodily injury, and for this reason you are requested to read all such instructions carefully and follow them without fail.

**NOTES ON TYPES OF WARNINGS IN THE MANUAL****▲ WARNING**

This mark indicates instructions, which must be followed in order to prevent accidents, which could lead to serious bodily injury or death.

**❗ IMPORTANT**

This mark indicates instructions, which must be followed, or it leads to mechanical failure, breakdown, or damage.

**📖 NOTE**

This mark indicates hints or directions useful in the use of the product.

**Contents**

1. Parts location .....	2
2. Specification .....	3
3. Warning labels on the machine .....	3
4. Symbols on the machine.....	3
5. For safe operation .....	4
6. Set up.....	7
7. Fuel .....	9
8. Operation .....	10
9. Maintenance .....	13
10. Storage.....	14

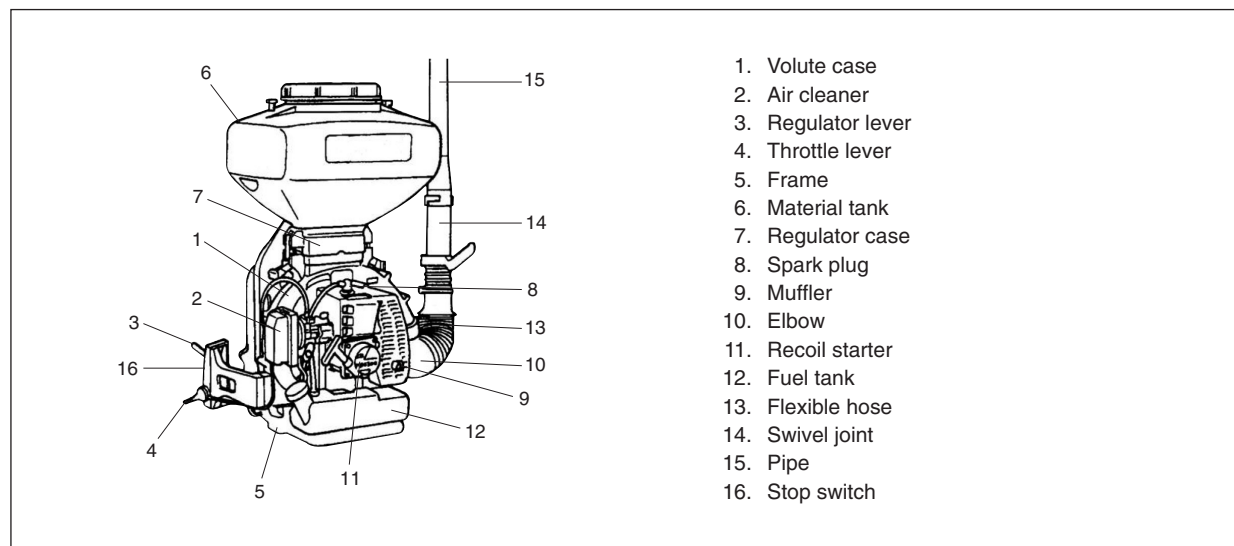
**1. Parts location**

## 2. Specification

Model		MD6210
Dry Weightkg		12.0
Over all size (L x W x H)mm		450 x 530 x 780
Materiall Tank Capacityℓ		28
Fuel Tank Capacityℓ		1.8
Max. FAN speed		7,800
Discharge	Powder	7
	Granule	14
Engine	Displacementcc	62.0
	Fuel Used	GASOLINE 25 : OIL 1 When using market oil (JASO FB grade oil or ISO-L-EGB grade oil) GASOLINE 50 : OIL 1 When using ZENOAH genuine oil, JASO FD grade oil or ISO-L-EGD grade oil
	Lubricating Oil Used	2-stroke engine oil
	Carburetor	Float
	Ignition system	CDI Fly wheel magneto
	Spark Plug	Champion RCJ 6Y
	Starting Method	Recoil starter

Specifications are subject to change without notice.

## 3. Warning labels on the machine



- (1) Read operator's instruction book before operating this machine.
- (2) Wear head, eye and ear protection.
- (3) Wear protective clothes.

## 4. Symbols on the machine

For safe operation and maintenance, symbols are carved in relief on the machine. According to these indications, please be careful not to make a mistake.



The port to refuel the "MIX GASOLINE"  
**Position:** FUEL TANK CAP

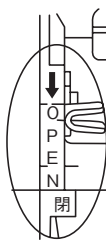

The direction to open the choke  
**Position:** Carburetor

## ▲ 5. For safe operation



1. Read this manual carefully until you completely understand and follow all safety and operating instructions.
2. Keep this manual handy so that you may refer to it later whenever any questions arise. Also note, if you have any questions which cannot be answered herein, contact the dealer from whom you purchased the product.
3. Always be sure to include this manual when selling, lending, or otherwise transferring the ownership of this product.
4. Never allow children or anyone unable to fully understand the directions given in the manual to use the machine.



### ■ WORKING CONDITION

1. When using the product, you should wear proper clothing and protective equipment.

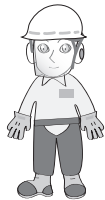

- (1) **Helmet**
- (2) **Ear protectors**
- (3) **Protection goggles or face protector**
- (4) **Thick work gloves**
- (5) **Non-slip-sole work boots**

2. And you should carry with you.
  - (1) Attached tools
  - (2) Properly reserved fuel
  - (3) Whistle (for collaboration or emergency)



3. Do not wear loose clothing, jewelry, short trousers, sandals, or go barefoot. Do not wear anything which might be caught by a moving part of the unit. Secure hair so it is above shoulder length.



### ■ WORKING CIRCUMSTANCE

1. Never start the engine inside a closed room or building. Exhaust gases contain dangerous carbon monoxide.
2. Never use the product,
  - (1) When the ground is slippery or when you can't maintain a steady posture.
  - (2) At night, at times of heavy fog, or at any other times when your



field of vision might be limited and it would be difficult to gain a clear view of the working area.

- (3) During rain storms, during lightning storms, at times of strong or gale-force winds, or at any other times when weather conditions might make it unsafe to use the product.

### ■ WORKING PLAN

1. You should never use the product when under the influence of alcohol, when suffering from exhaustion or lack of sleep, when suffering from drowsiness as a result of having taken cold medicine or at any other time when a possibility exists that your judgment might be impaired or that you might not be able to operate the product properly and in a safe manner.
2. When planning your work schedule, allow plenty of time to rest. Limit the amount of time over which the product is to be used continuously to somewhere around 30 ~ 40 minutes per session, and take 10 ~ 20 minutes of rest between work sessions. Also try to keep the total amount of work performed in a single day under 2 hours or less.



### ▲ WARNING

1. If you don't observe the working time, or working manner, Repetitive Stress Injury (RSI) could occur.  
If you feel discomfort, redness and swelling of your fingers or any other part of your body, see a doctor before getting worse.
2. To avoid noise complaints, in general, operate product between 8 a.m. and 5 p.m. on weekdays and 9 a.m. to 5 p.m. on weekends.



### NOTE

Check and follow the local regulations as to sound level and hours of operations for the product.

## ▲ 5. For safe operation

### ■ FILLING CHEMICALS INTO THE TANK



1. Before filling the sprayer tank with chemicals, make sure to check if a bottom shutter (outlet valve) of the tank is fully closed. Opened shutter is dangerous because chemicals will be sprayed simultaneously with the engine start.
2. Tighten the tank cap securely after filling chemicals. Loose cap may cause danger of chemicals spout of the tank during use.

### ■ PRECAUTIONS ON SPRAYING MATERIAL

1. Carefully read the indications attached to the material and use in a proper way.
2. When spraying, take full notice of environmental safety.
3. Avoid working long under a hot sun. A windless morning or evening is recommended to carry out the job.
4. After replenishing material, securely tighten the tank cap.
5. When spraying material, do not inhale it or let it become stuck to you. If you feel dizzy or has a headache during the work, immediately stop the work and consult a doctor.
6. Length of the multi-head hose shall be adequate to match the capacity of a blower of the sprayer. Hand supporting of a hose which is sagged during an operation by an assistant is extremely dangerous and definitely be avoided.



### ■ STARTING THE ENGINE

1. Keep bystanders and animals at least 15 m away from the operating point. If you are approached, immediately stop the engine.
2. Check if an adjust lever (outlet valve open/close lever) is in full close position. Otherwise, large volumes of chemicals spout immediately with the engine start and are dangerous.
3. Assure that there is no person in front of a spray head (output nozzle) when starting the engine. Remaining chemicals stuck in a spray pipe may spout out.

### ■ USING THE PRODUCT

#### ① IMPORTANT

1. If the unit starts to shake or vibrate, turn off the engine and check the whole unit. Do not use it until the trouble has been properly corrected.
2. Keep all parts of your body away from rotating attachment and hot surfaces.
3. Never touch the muffler, spark plug, or other metallic parts of the engine while the engine is in operation or immediately after shutting down the engine. Doing so could result in serious burns or electrical shock.

### ■ IF SOMEONE COMES

1. Warn adults to keep pets and children away from the area. Be careful if you are approached. Injury may result from flying debris.
2. If someone calls out or otherwise interrupts you while working, always be sure to turn off the engine before turning around.

### ■ MAINTENANCE

1. In order to maintain your product in proper working order, perform the maintenance and checking operations described in the manual at regular intervals.
2. Always be sure to turn off the engine and disconnect the spark plug wire before performing any maintenance or checking procedures.

#### ▲ WARNING

**The metallic parts reach high temperatures immediately after stopping the engine.**

3. When replacing the part, or when replacing the oil or any lubricant, always be sure to **use only ZENOAH products or products which have been certified by ZENOAH for use with the ZENOAH product.**
4. In the event that any part must be replaced or any maintenance or repair work not described in this manual must be performed,

GB

GB-5

## ▲ 5. For safe operation

please contact a representative from the store nearest ZENOAH authorized servicing dealer for assistance.

5. Do not use any accessory or attachment other than those bearing the ZENOAH mark and recommended for the unit.
6. Under no circumstances should you ever take apart the product or alter it in any way. Doing so might result in the product becoming damaged during operation or the product becoming unable to operate properly.

### ■ HANDLING FUEL

1. The engine of the ZENOAH product is designed to run on a mixed fuel, which contains highly flammable gasoline. Never store cans of fuel or refill the tank of the unit in any place where there is a boiler, stove, wood fire, electrical sparks, welding sparks, or any other source of heat or fire which might ignite the fuel.
2. Never smoke while operating the unit or refilling its fuel tank.
3. When refilling the tank, always turn off the engine and allow it to cool down. Take a careful look around to make sure that there are no sparks or open flames anywhere nearby before refueling.
4. Wipe spilled fuel completely using a dry rag if any fuel spillage occurs during refueling.
5. After refueling, screw the fuel cap back tightly onto the fuel tank and then carry the unit to a spot 3 m or more away from where it was refueled before turning on the engine.



### ■ TRANSPORTATION

1. Never transport the product over rough roads over long distances by vehicle without removing all fuel from the fuel tank. If doing so, fuel might leak from the tank during transport.

### ■ AFTER THE EXTERMINATION OPERATION

1. Protective gears as protective suits, agrichemical masks, gloves etc. shall be inspected and cared for the next operation.
2. Upon completion of all extermination operation including clean up of agrichemicals, machines, etc., immediately take shower or wash your hands, legs, face, etc. with soap also gargle.
3. Change all wears including underwear and wash them thoroughly. Do not wear again those unwashed wears used for the operation on the next day.

## 6. Set up

### ■ CONNECTION OF EARTH CHAIN

#### ⚠ WARNING

**Spray of chemicals in dry air may generate high static electricity due to the friction. To avoid electric shocks, an earth chain shall be attached.**

1. Slacken a screw inside of an elbow of the blower. Insert a part of the earth chain into a gap between the screw and the main body. Fix with the screw.
2. Apply a clamp (large) onto a larger end of the attached flexible hose. Insert a wire of the earth chain into the hose. Securely fit the hose on the elbow.
3. Fix the hose securely by tightening a clamp screw using a screwdriver.

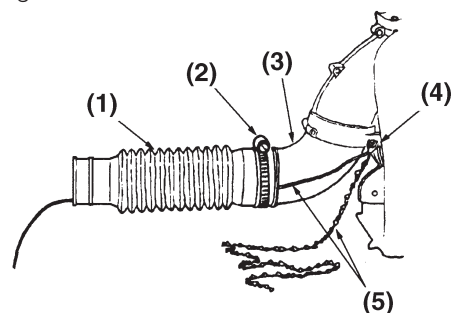

- (1) Flexible hose
- (2) Clamp(Large)
- (3) Elbow
- (4) Screw
- (5) Earth chain

### ■ CONNECTION OF BLOWER

1. Connect the blower pipes securely
2. Connect the joint to the flexible hose and fix with the clamp.

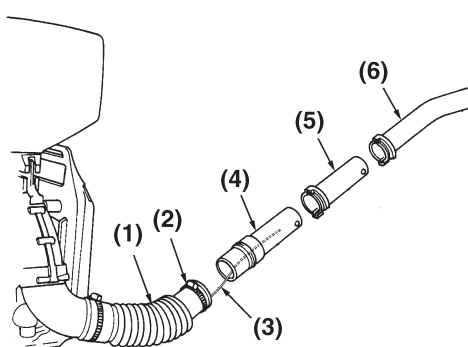

- (1) Flexible hose
- (2) Clamp
- (3) Wire
- (4) Joint
- (5) Straight pipe
- (6) Bent pipe

### ■ HOW TO CONNECT A JET HOSE (OPTION)

1. Remove a ring from an attached adapter.
2. Fit an end of jet hose on a larger end of the adapter. Apply the ring from a smaller end of the adapter and securely fit the jet hose.
3. Insert the adapter into the flexible hose and securely fix with a clamp (small).

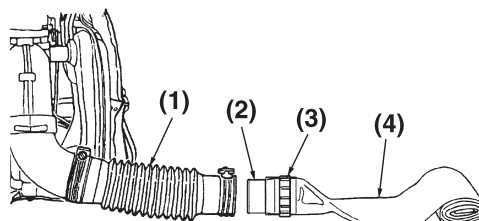

- (1) Flexible hose
- (2) Adapter
- (3) Ring
- (4) Jet hose (holes to face down)

MD6210 is equipped with an outlet volume changer mechanism.

The volume is initially set to a "High rate" position in our factory. Depend on your spray condition, change it to an adequate position.

#### NOTE

For Flow dust (FD) powder agents and 1kg-Weed killers, set to the "Small rate" position.

GB

## 6. Set up

### ■ HOW TO CHANGE

1. Pull a rod on backrest side of the chemical tank holder and disengage from the change arm.
2. Insert an upper end of the rod into a required position hole.

### NOTE

In case the rod length does not match with the hole position, adjust the length in following manner:

1. Put the adjust lever to a "Full open" position
2. Push up the change arm with fingers to a "Full open" position.
3. Slacken a lock nut on a lower end of the rod and turn the rod till the upper end of the rod come to a "High rate" position. Right turn of the rod shortens it and left turn makes it longer. Tighten the lock nut after the adjustment.

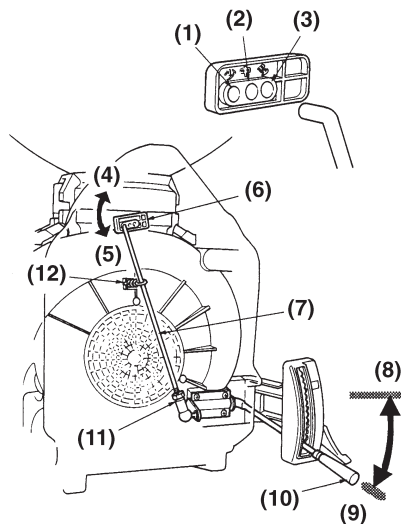

- |                   |                     |
|-------------------|---------------------|
| (1) "Small rate"  | (7) Rod             |
| (2) "Medium rate" | (8) Full Open       |
| (3) "High rate"   | (9) Full Close      |
| (4) Full Open     | (10) Adjust lever   |
| (5) Full Close    | (11) Lock Nut       |
| (6) Change arm    | (12) Stopper spring |

### ❗ IMPORTANT

- Inadequate rod length may cause the rod disengaged or the shutter improperly operated.
- Even for an operation at "Small rate" or "Medium rate", adjustment of the rod length shall be made to "High rate" position hole. Otherwise, it may cause an excessive discharge.



## 7. Fuel

### ■ FUEL

#### ▲ WARNING

- **Gasoline is very flammable. Avoid smoking or bringing any flame or sparks near fuel. Make sure to stop the engine and allow it cool before refueling the unit. Select outdoor bare ground for fueling and move at least 3 m (10 ft) away from the fueling point before starting the engine.**



- The Zenoah engines are lubricated by oil specially formulated for air-cooled 2-stroke gasoline engine use. If Zenoah oil is not available, use an anti-oxidant added quality oil expressly labeled for air-cooled 2-stroke engine use (JASO FD GRADE OIL or ISO-L-EGD GRADE).
- Do not use BIA or TCW (2-stroke water-cooling type) mixed oil.



### ■ RECOMMENDED MIXING RATIO

#### GASOLINE 25 : OIL 1

When using market oil (JASO FB grade oil or ISO-L-EGB grade oil)

#### GASOLINE 50 : OIL 1

When using ZENOAH genuine oil, JASO FD grade oil or ISO-L-EGD grade oil

- **Exhaust emission are controlled by the fundamental engine parameters and components (eq., carburation, ignition timing and port timing) without addition of any major hardware or the introduction of an inert material during combustion.**
- These engines are certified to operate on unleaded gasoline.
- Make sure to use gasoline with a minimum octane number of 89RON (USA/Canada: 87AL).
- If you use a gasoline of a lower octane value than prescribed, there is a danger that the engine temperature may rise and an engine problem such as piston seizing may consequently occur.
- Unleaded gasoline is recommended to reduce the contamination of the air for the sake of your health and the environment.
- Poor quality gasolines or oils may damage sealing rings, fuel lines or fuel tank of the engine.

### ■ HOW TO MIX FUEL

#### ▲ WARNING

- **Pay attention to agitation.**

1. Measure out the quantities of gasoline and oil to be

mixed.

2. Put some of the gasoline into a clean, approved fuel container.
3. Pour in all of the oil and agitate well.
4. Pour in the rest of gasoline and agitate again for at least one minute. As some oils may be difficult to agitate depending on oil ingredients, sufficient agitation is necessary for the engine to last long. Be careful that, if the agitation is insufficient, there is an increased danger of early piston seizing due to abnormally lean mixture.
5. Put a clear indication on the outside of the container to avoid mixing up with gasoline or other containers.
6. Indicate the contents on outside of container for easy identification.

### ■ FUELING THE UNIT

1. Untwist and remove the fuel cap. Rest the cap on a dustless place.
2. Put fuel into the fuel tank to 80% of the full capacity.
3. Fasten the fuel cap securely and wipe up any fuel spillage around the unit.

#### ▲ WARNING

1. **Select flat and bare ground for fueling.**
2. **Move at least 10 feet (3 meters) away from the fueling point before starting the engine.**
3. **Stop the engine before refueling the unit. At that time, be sure to sufficiently agitate the mixed gasoline in the container.**

### ■ FOR YOUR ENGINE LIFE, AVOID:

1. **FUEL WITH NO OIL (RAW GASOLINE)** – It will cause severe damage to the internal engine parts very quickly.
2. **GASOHOL** – It can cause deterioration of rubber and/or plastic parts and disruption of engine lubrication.
3. **OIL FOR 4-CYCLE ENGINE USE** – It can cause spark plug fouling, exhaust port blocking, or piston ring sticking.
4. **Mixed fuels which have been left unused for a period of one month or more** may clog the carburetor and result in the engine failing to operate properly.
5. In the case of storing the product for a long period of time, clean the fuel tank after rendering it empty. Next, activate the engine and empty the carburetor of the composite fuel.
6. In the case of scrapping the used mixed oil container, scrap it only at an authorized repository site.

#### NOTE

As for details of quality assurance, read the description in the section Limited Warranty carefully. Moreover, normal wear and change in product with no functional influence are not covered by the warranty. Also, be careful that, if the usage in the instruction manual is not observed as to the mixed gasoline, etc. described therein, it may not be covered by the warranty.

GB

GB-9

## 8. Operation

### ■ STARTING ENGINE

1. Fill the fuel tank with fuel, and turn the cap to the tank to make sure that it is fixed on tightly.

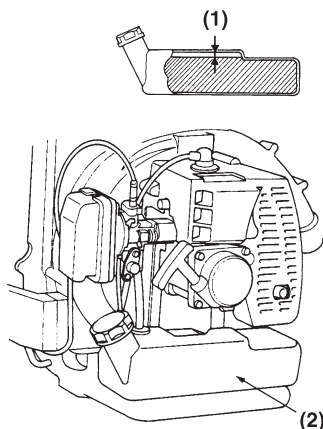

- (1) More than 5mm  
hight space  
(2) Fuel tank

### ❗ IMPORTANT

When refueling the tank, remain more than 5mm high space inside the tank.

2. Push the primer pump several times until over-flown fuel flows out in the clear tube.
3. Move the choke lever to the closed position.

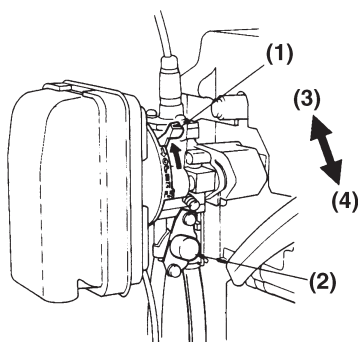

- (1) Choke lever  
(2) Primer pump  
(3) Close  
(4) Open

### 📖 NOTE

When restarting immediately after stopping the engine, move the choke lever to the opened position.

4. Set the throttle lever to the "START" position.

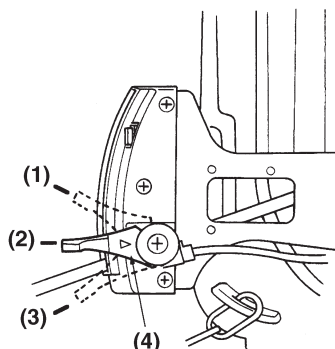

- (1) Full  
(2) Start  
(3) Idle  
(4) Throttle lever

5. To start, hold the top of the duster firmly with your left hand. Pull the starter knob slowly until you feel it engage and then give it a vigorous strong pull.

- **Avoid pulling the starter rope out to its full extension. Do not allow the starter rope to snap back. Rewind the rope slowly. This will prevent premature damage to the starter.**

6. Once the engine is running, gradually open the choke if it was set closed, and let the engine run at idle speed for a minute to warm it up.

### 📖 NOTE

When the engine failed to start after Several attempts due to overchoking, open the choke and repeat pulling the rope.

### ■ "DECOMP" VALVE

An engine on MD6210 is equipped with a "Decomp" valve (decompression valve) to lighten rope tension for starting the engine. Air leakage noise can be heard by pulling the rope for starting the engine. This is not an irregular status; as the engine starts, the valve is automatically closed and the engine works same as other engines.

### [Clear button]

After usages, the valve may be locked with contamination in the engine that makes the rope heavy. In such a case, push the Clear button 1 or 2 times with your finger before starting the engine. The valve will return to a normal position and the function is recovered.

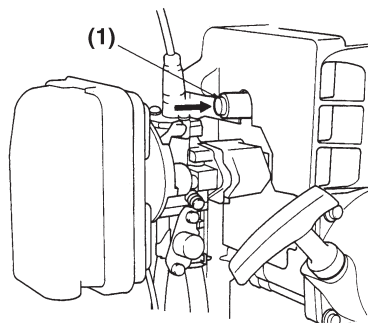

- (1) Clear button

## 8. Operation

### ■ STOPPING ENGINE

1. Move the regulator lever to the bottom position.
2. After checking that the powder/granule stops, move the throttle lever to the idle position.
3. Press the stop switch until the engine stops completely.

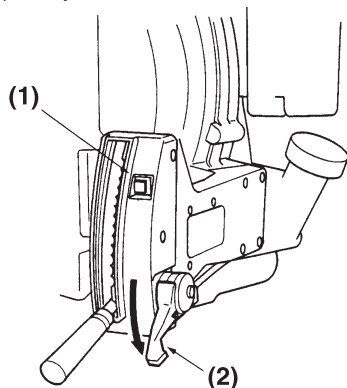

(1) Stop switch  
(2) Throttle lever

### ■ CHARGING CHEMICALS (FERTILIZERS/AGRICHEMICALS)

#### ▲ WARNING

- To charge chemicals into the sprayer tank, stop the engine and fully down the adjust lever. In case the adjust lever is in upper position (the shutter is opened), it is dangerous as chemicals will be sprayed simultaneously with the engine start.
- Tighten the tank cap securely after filling chemicals. Loose cap may cause danger of chemicals spout of the tank during use.

#### ❗ IMPORTANT

- Leaving chemicals in the tank for long time may cause insufficient output volume or incorrect shutter action due to moisture. Remaining chemicals shall be separately put into a storage container within the same day.
- To carry the sprayer by vehicles, empty the chemical tank. Otherwise, chemicals may be tamped down by vibration and cause insufficient output failure.

#### ▲ WARNING

1. Always work from the windward side.
2. Be alert to bystanders or fragile things in the blowing direction.

1. Put material into the tank with the regulator lever kept at the bottom position. If the regulator is opened, the material will blow out concurrently with the start of the engine.
2. Tighten the tank cap securely.
3. Start the engine and carry the unit on your back.

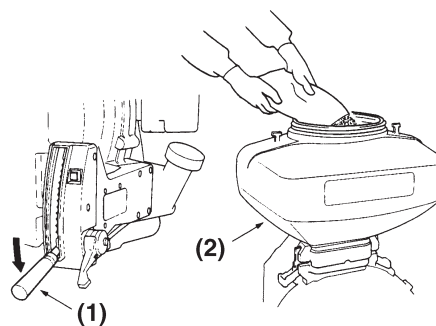

(1) Regulator lever (2) Tank

### ■ SETTING THROTTLE LEVER

Set the throttle lever to the full throttle position at the time of spraying work.

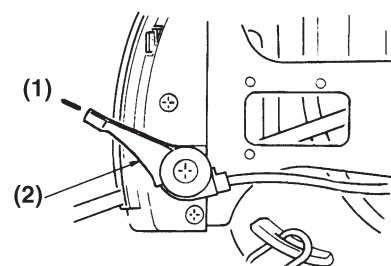

(1) Full throttle (2) Throttle lever

### ■ SETTING ADJUST LEVER STOPPER

To maintain shutter opening at a same level for a spray operation, set an adjust lever stopper on a required position.

1. Slide the stopper while pulling the knob.
2. Release the knob when the stopper is on one notch above the required opening.

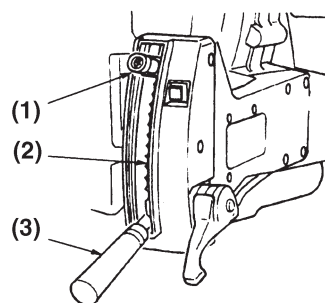

(1) Stopper  
(2) Notch  
(3) Adjust Lever

GB

## 8. Operation

### ■ ADJUSTMENT OF DISCHARGE RATE

#### ❗ IMPORTANT

- Discharge rate can be varied according to grade and dryness of chemicals
- As granular agents are uneasy to distinguish, care should be taken not to spray excess volumes.
- To avoid uneven sprays, try to keep constant walking speed during the operation.

Fig.1 – 3 show relation between the adjust lever opening and the Discharge rate for each type of chemicals.

By referring those Figures based on your applied chemicals and operation conditions (i.e. spray area, spray equipment, walking speed, etc.), set the adjust lever at an adequate position.

F1

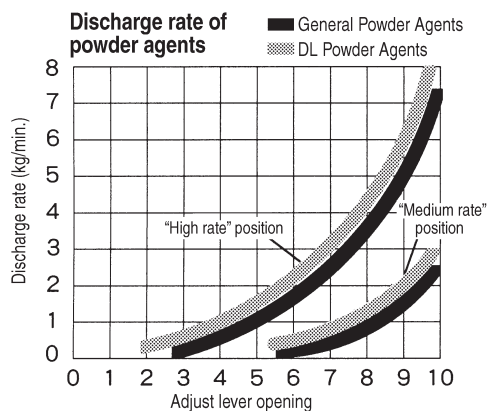

F2

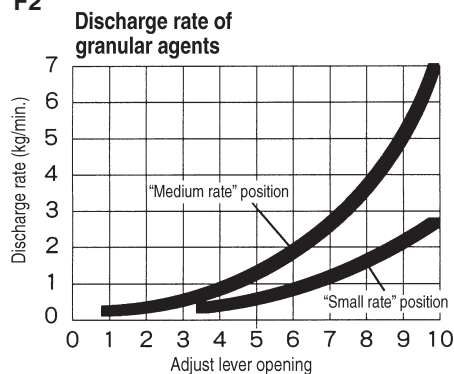

F3

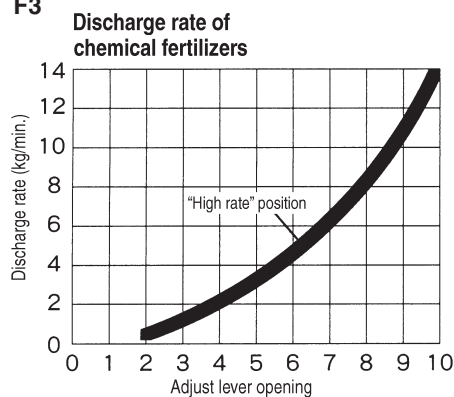

## 9. Maintenance

### ⚠ WARNING

Before maintenance make sure to stop the engine and cool down it.

### ■ SPRAY DEVICE

#### ❗ IMPORTANT

- As fertilizers are easy to absorb moisture, left behind fertilizers will cause error for the shutter operation. After spraying fertilizers, clean the spray device carefully.
- Correct length of the chemical tank locking hooks is 45-46mm. Shorter hooks than this cause excess fixing forces and may end up with deformation or breakage of related components. Longer hooks cause insufficient contact of the tank and chemicals may leak.
- For long time storage of the sprayer, leave the chemical tank cap loose. Otherwise, a cap gasket may be deformed.
- When the tank becomes empty, increase the engine speed, and up and down the adjust lever several times to blow away adhered chemicals from the shutter, inside of the blower, spray head, etc.
- Periodically detach the chemical tank and remove chemicals adhered to the shutter case.

#### How to Detach the Chemical Tank

- Disengage the adjust rod from the change arm. (Refer Page 8)
- Push up tank fixing levers on both sides of the blower top, and remove hooks.

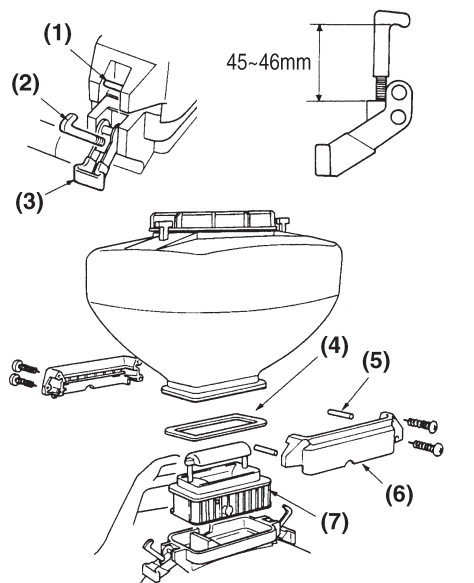

- |           |            |                  |
|-----------|------------|------------------|
| (1) Pin   | (4) Gasket | (6) Clamp        |
| (2) Hook  | (5) Pin    | (7) Shutter case |
| (3) Lever |            |                  |

### ■ AIR FILTER

Acclogged air filter will reduce the engine performance. Check periodically and clean the filter element in warm, soapy water as required. Dry completely before installing. If the element is broken or shrunk, replace with a new one.

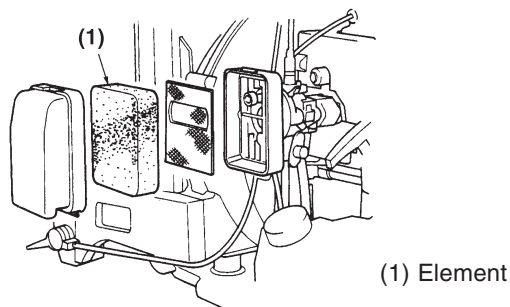

(1) Element

### ■ FUEL FILTER

When the engine runs short of fuel supply, check the fuel filter for blockage.

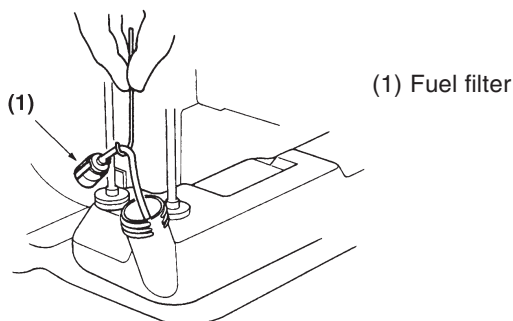

(1) Fuel filter

### ■ SPARK PLUG

Starting failure and mis-firing are often caused by a fouled spark plug. Periodically clean the spark plug, and replace with a new one as required.

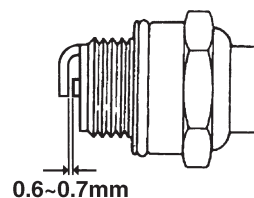

0.6~0.7mm

Type of plug:

Champion RCJ6Y

NGK BPMR7A

Spark gap: 0.6~0.7mm

GB

## 9. Maintenance

### ■ ADJUSTING ENGINE

Although the engine is initially tuned in our factory, re-adjustments may become necessary depend on operating conditions (running-in of the engine, change of air density, etc.).

#### Idle speed adjustment

In case the engine stalls or runs at too high speed when the throttle lever is fully down, use the idle speed adjust screw for readjustment of the idle speed.

1. Start the engine and set the engine run at middle speed for a few minute to worm up.
2. Return the throttle to the idle position and adjust the idle screw.

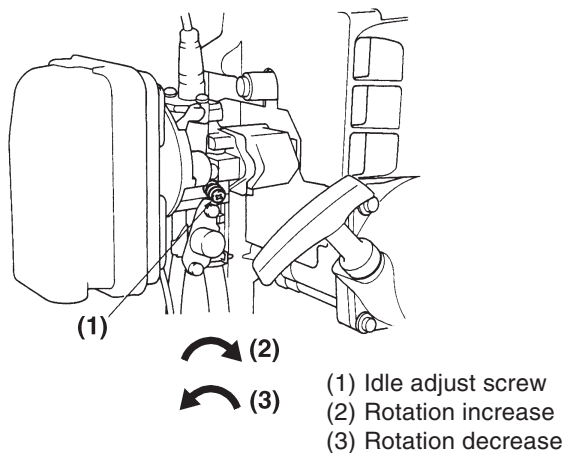

## 10. Storage

- When a series of operation finished, make sure to empty the fuel tank.
- Remove the material tank and clean.
- Remove the spark plug and put in 1~2 cc of 2-cycle oil in the engine. Pull the starter rope 2~3 times, set the plug back, and stop it at the contraction position.
- Apply anti-rust oil to the metal parts such as the throttle wire etc., put the cover on the blade, and keep it indoor avoiding dampness.

### ❗ IMPORTANT

MD6210 need not to drain the carburetor.

## Limited warranty

**Should any failure occur on the product under normal operating conditions within the applicable warranty period, the failed part will be replaced or repaired free of charge by a ZENOAH authorized dealer.**

WARRANTY PERIOD: Six (6) months after purchased by end-user subject to 12 months from produced month. (30 days if used for rental purpose)

THE PURCHASER SHALL BEAR COSTS OF TRANSPORTING THE UNIT TO AND FROM THE ZENOAH DEALER.

THE PURCHASER SHALL NOT BE CHARGED FOR DIAGNOSTIC LABOR WHICH LEADS TO THE DETERMINATION THAT A WARRANTED PART IS DEFECTIVE, IF THE DIAGNOSTIC WORK IS PERFORMED AT THE ZENOAH DEALER.

THE PURCHASER OR OWNER IS RESPONSIBLE FOR THE PERFORMANCE OF THE REQUIRED MAINTENANCE AS DEFINED BY THE MANUFACTURER IN THE OWNER/OPERATOR MANUAL.

ANY WARRANTED PART WHICH IS NOT SCHEDULED FOR REPLACEMENT AS REQUIRED MAINTENANCE, OR WHICH IS SCHEDULED ONLY FOR REGULAR INSPECTION TO THE EFFECT OF REPAIR OR "REPLACE AS NECESSARY" SHALL BE WARRANTED FOR THE WARRANTY PERIOD. ANY WARRANTED PART WHICH IS SCHEDULED FOR REPLACEMENT AS REQUIRED MAINTENANCE SHALL BE WARRANTED FOR THE PERIOD OF TIME UP TO THE FIRST SCHEDULED REPLACEMENT POINT FOR THE PART.

ANY REPLACEMENT PART THAT IS EQUIVALENT IN PERFORMANCE AND DURABILITY MAY BE USED IN NON-WARRANTY MAINTENANCE OR REPAIRS, AND

SHALL NOT REDUCE THE WARRANTY OBLIGATION OF THE COMPANY.

THE COMPANY IS LIABLE FOR DAMAGES TO OTHER ENGINE COMPONENTS CAUSED BY THE FAILURE OF A WARRANTED PART STILL UNDER WARRANTY.

**THE WARRANTY DOES NOT APPLY TO** THOSE UNITS WHICH HAVE BEEN DAMAGED BY NEGLIGENCE OF INSTRUCTION LISTED IN THE OWNER/OPERATOR MANUAL FOR PROPER USE AND MAINTENANCE OF THE UNITS ACCIDENT MISHANDLING, ALTERATION, ABUSE, IMPROPER LUBRICATION, USE OF ANY PARTS OR ACCESSORIES OTHER THAN THOSE SPECIFIED BY THE COMPANY, OR OTHER CAUSES BEYOND THE COMPANY'S CONTROL.

**THIS WARRANTY DOES NOT COVER** THOSE PARTS REPLACED BY NORMAL WEAR OR HARMLESS CHANGES IN THEIR APPEARANCE.

**THERE ARE NO OTHER EXPRESS WARRANTIES.**

**ANY IMPLIED WARRANTY** is limited to the duration of the limited warranty. Otherwise, this limited warranty is in lieu of all other expressed or implied warranties, including any warranty of **FITNESS FOR A PARTICULAR PURPOSE OR USE** and any implied warranty **MERCHANTABILITY** otherwise applicable to this product.

**LIABILITIES FOR INCIDENTAL OR CONSEQUENTIAL DAMAGE UNDER ANY AND ALL WARRANTIES ARE EXCLUDED.**

IF YOU NEED TO OBTAIN MORE INFORMATION, PLEASE CALL YOUR NEAREST SERVICE CENTER, OR CHECK PLEASE ZENOAH WEB SITE:

<http://www.zenoah.net>

GB

