

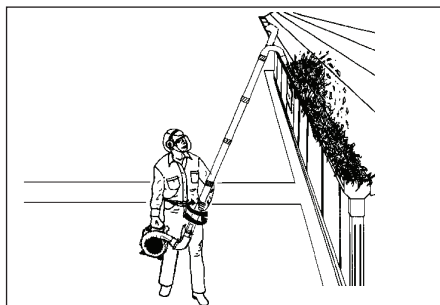

OWNER/OPERATOR MANUAL MANUEL D'INSTRUCTIONS MANUAL DE INSTRUCCIONES



GUTTER CLEAN-OUT ATTACHMENT

DISPOSITIF DE NETTOYER DES GOUTTIÈRES

DISPOSITIVO DE LIMPIEZA DE CANALONES

GK-280

WARNING

Before using our products, please read this manual carefully to understand the proper use of your unit.



AVERTISSEMENT

Avant d'utiliser cette ce produit, veuillez lire attentivement ce manuel afin de bien comprendre le bon fonctionnement de cet appareil



ADVERTENCIA



Antes de usar nuestros productos, lea detenidamente este manual a fin de familiarizarse con el uso correcto de este aparato.

APPLICABLE MODELS:

HB280

MODÈLES APPLICABLES :

HB280

MODELOS APLICABLES:

HB280

CONTENTS

Contents

Introduction	22
Key to symbols	22
Safety instructions	23
Description	24
Assembly	25
Use	26

Note the following before starting:

RedMax has a policy of continuous product development and therefore reserves the right to modify the design and appearance of products without prior notice. Long-term exposure to noise can result in permanent hearing impairment. Always use approved hearing protection.



Read through the operator's manual carefully and understand the content before using the machine.

These instructions supplement the instructions that were included with the machine. For other procedures, please refer to the operating instructions for the machine.



WARNING: Under no circumstances may the design of the machine be modified without the permission of the manufacturer. Always use genuine accessories. Non-authorized modifications and/or accessories can result in serious personal injury or the death of the operator or others. Your warranty may not cover damage or liability caused by the use of non-authorized accessories or replacement parts.

KEY TO SYMBOLS

Symbols



WARNING! The blower can be dangerous! Careless or improper use can cause serious, even fatal injury.



Read the operator's manual carefully and make sure that you understand the contents before using the blower.



Approved protective goggles or visor, ear protection, and face mask in dusty environments must be worn.



WARNING! Never touch the impeller unless the unit is off, the impeller has stopped moving and the spark plug is disconnected.



Always wear approved, protective gloves.



WARNING! The blower may throw objects at high velocity that can ricochet and hit the operator. This may cause serious eye damage.



The blower operator must make sure that no bystanders or animals come nearer than 50 feet (15 meters). Whenever several operators are working in the same work area, they should maintain a safe distance of at least 50 feet (15 meters) from one another.

SAFETY INSTRUCTIONS

Personal safety equipment

Persons who use the blower shall wear the following safety equipment:

1. Approved ear protection.
2. Approved eye protection.
3. Approved protective gloves.
4. Boots or work shoes with a non-slip sole.
5. Face mask when operating the blower in dusty environments.

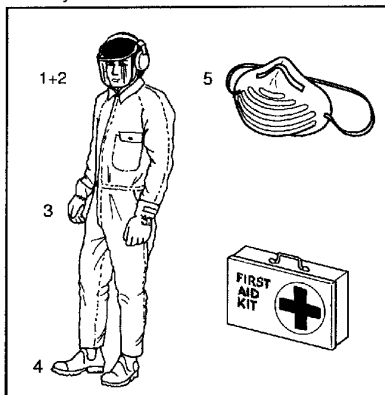

Personal safety

The following instructions apply to persons operating the blower:

- The operator shall have read and understood the contents of this owner/operator manual and the owner/operator manual for the Model HB280 blower unit.
- Do not wear loose clothing, scarves or neckchains or let long hair hang loose, since these can be drawn into rotating parts of the blower and cause injury.
- Do not operate the blower while under the influence of alcohol, drugs or when you are tired.
- Do not allow minors to operate the blower.
- Always have a first aid kit nearby.

Safety while operating the blower

- Do not allow bystanders or animals to be in the work area, i.e. 50 feet (15 meters) from the operator.
- The blower may throw objects at high velocity that can ricochet and hit the operator. This may cause serious eye damage.
- Never point the blower nozzle toward people or animals.
- Stop the engine before fitting or dismantling accessories or other components.
- Never operate the blower if any of the guards are missing.
- Never operate the blower in poorly ventilated spaces where exhaust fumes might otherwise be inhaled.

- Stop the engine before refueling. Move the unit at least 10 feet (3 meters) from fueling site before attempting to start.
- The catalytic muffler is extremely hot while the blower is running and after it has stopped. The same applies when the blower is running at idling speed. Be aware of the danger of fire, especially while operating the blower near flammable materials and/or where flammable fumes are present.
- Be careful, particularly if left hand operation is applied. Avoid any direct body contact with inlet cover area. Keep jewelry, loose clothing, or clothing with loosely hanging straps, ties, tassels, etc., away from inlet cover area.
- Do not operate the blower while standing on a ladder or a stand.

Other safety measures

- Operate the blower only at reasonable hours, i.e. not early in the morning or late at night when people might be disturbed. Comply with times listed in local ordinances. Usual recommendations are 9:00 a.m. to 5:00 p.m., Monday through Saturday.
- To reduce sound levels, limit the number of pieces of equipment used at any one time.
- Operate the blower at the lowest possible throttle setting to do the job.
- Check air intake opening and tubes frequently, always with engine stopped and spark plug disconnected. Keep vents and discharge tubes free of debris which can accumulate and restrict proper air flow.
- Watch out for children, pets, open windows or vehicles, and blow debris safely away.
- After using the blower, clean up and dispose of debris in trash receptacles.

DESCRIPTION

Model GK-280 Gutter Clean-out Attachment - Part No. 952711678

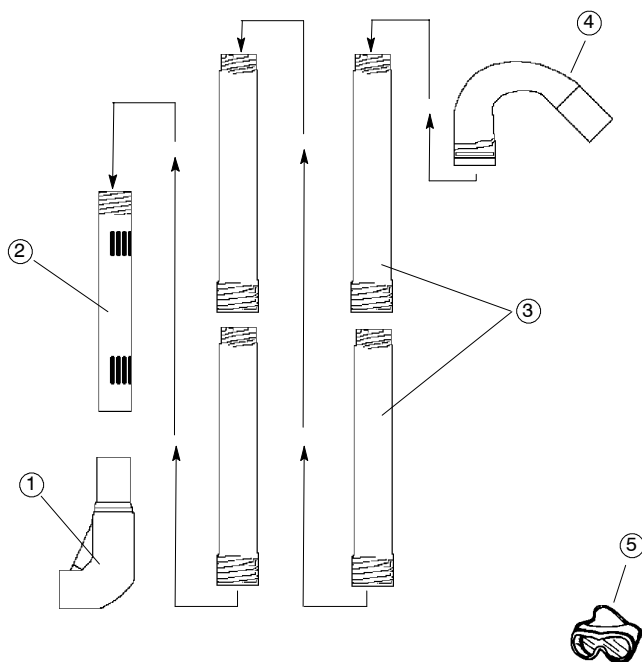

	Part No.	Description
1.	545142901	Elbow tube
2.	530094424	Pivot tube
3.	530094425	Extension tubes (4)
4.	530094426	Nozzle
5.	952701645	Goggles

ASSEMBLY

Fitting the various gutter kit tubes



WARNING: When fitting the gutter kit tubes, the engine must be switched off.

1. Remove tube clamp bolt.
2. Align slot in the blower air outlet with the raised rib on the elbow tube (A) and insert tube into outlet.
3. Re-insert tube clamp bolt and tighten.
4. Push the slotted end of the pivot tube (B) over the elbow until the flange (C) bottoms out in the elbow groove (D).

NOTE: Be sure flange snaps into groove.

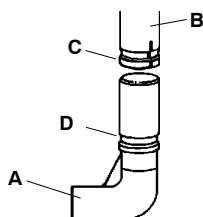

5. Test rotating action of the pivot tube by rotating the pivot tube right and left.
6. Assemble extension tubes up to a total of 4, depending on the height of gutter to be cleaned.
7. Thread nozzle onto the last tube.

NOTE: Make sure threaded joints (tubes and nozzle) are securely tightened.

8. Align the tube assembly in a vertical position.
9. Thread extension tube assembly onto the end of the pivot tube.

USE

Cleaning gutters

Before cleaning gutters, put on the required safety equipment.



WARNING: When working with the blower, wear the required personal safety equipment:

1. Hearing protection.
2. Eye protection.
3. Protective gloves.
4. Face mask in dusty environments.



WARNING: To prevent personal injury, follow all safety instructions shown in this owner/operator manual and the owner/operator manual for the Model HB280 blower unit.

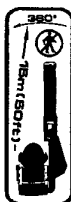
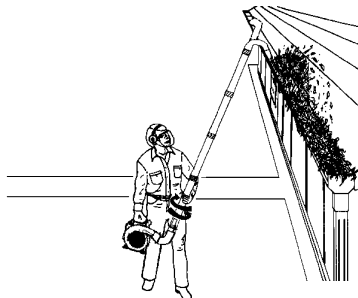

WARNING: Do not operate the blower while standing on a ladder or a stand.



WARNING: Hold the unit as illustrated when starting. Do not set unit on any surface except a clean, hard area when starting and/or using the unit. Debris such as gravel, sand, dust, grass, etc could be picked up by the air intake and thrown out through the discharge opening, damaging the unit or property, or causing serious injury to bystanders or the operator.

NOTE: When starting the blower, lean the top of the gutter attachment against a wall, tree, etc., for support.

Start the blower. Work according to the following instructions:

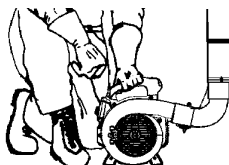

1. Support the gutter attachment with one hand as soon as the engine or motor starts.

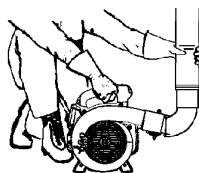

2. Stand 3 to 4 feet (1 to 1,25 meters) away from building.
3. Rotate the pivot tube to position the nozzle right or left.



Printed in U.S.A.