

Flymo

Pac a Shredder

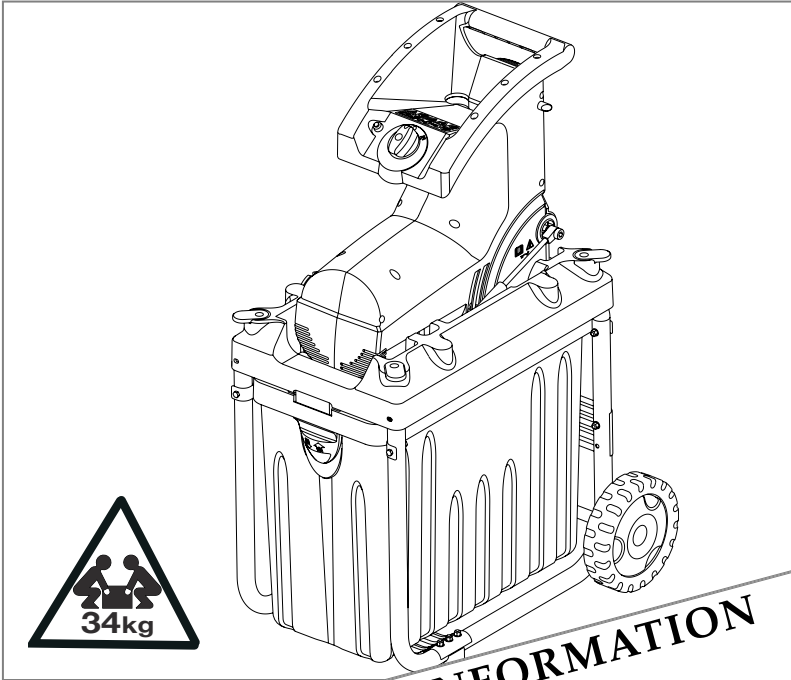

IMPORTANT INFORMATION
Read before use
& retain for future reference



For all customer enquiries or for replacement parts, contact:-

☎ 0870 609 1901

🖱 www.flymo.com



customer.services@husqvarna.co.uk

Carton Contents

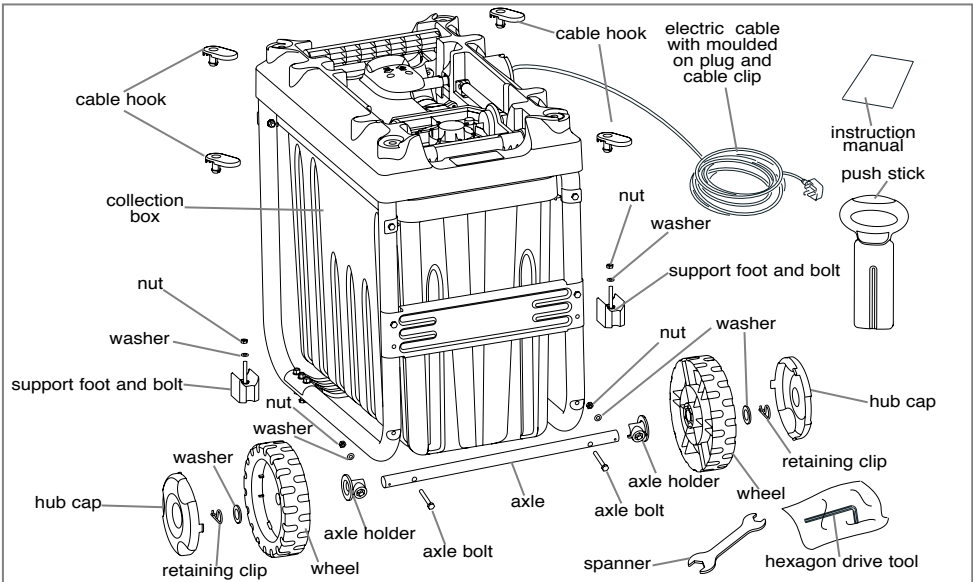

IMPORTANT !

Please check the contents of the carton are correct **BEFORE** assembling your new Flymo product.

IF ANY PARTS ARE MISSING CONTACT:-

Husqvarna Outdoor Products Customer Service Department direct
Telephone : 0870 609 1901 Fax : 0870 609 1902

Safety



If not used properly this product can be dangerous! This product can cause serious injury to the operator and others, the warnings and safety instructions must be followed to ensure reasonable safety and efficiency in using this product. The operator is responsible for following the warning and safety instructions in this manual and on the product. Never use the product unless the collection box or guards provided by the manufacturer are in the correct position.

Explanation of Symbols on your Product



Warning



Read the user instructions carefully to make sure you understand all the controls and what they do.



Keep bystanders away. Do not shred whilst people especially children or pets are in the area



Switch off! Remove plug from mains before adjusting, cleaning or if cable is entangled or damaged. Keep the cable away from moving parts.



Danger rotating blades. Keep hands out of openings when machine is running.



Cutting blade continues to rotate after the machine is switched off. Wait until all machine components have completely stopped before touching them.



Do not use in the rain or leave the product outdoors while raining



Wear eye protection



Wear Gloves

General

1. Never allow children or people unfamiliar with these instructions to use the product. Local regulations may restrict the age of the operator.
2. Only use the product in the manner and for the functions described in these instructions.
3. Never operate the product when you are tired, ill or under the influence of alcohol, drugs or medicine.
4. The operator or user is responsible for accidents or hazards occurring to other people or their property.

Electrical

1. The British Standards Institute recommend the use of a Residual Current Circuit Device (R.C.D.) with a tripping current of not more than 30mA. Even with a R.C.D. installed 100% safety cannot be guaranteed and safe working practice must be followed at all times. Check your R.C.D. every time you use it.
2. Before use, examine cable for damage, replace it if there are signs of damage or ageing.
3. Do not use the product if the electric cables are damaged or worn
4. Immediately disconnect from the mains electricity supply if the cable is cut, or the insulation is damaged. Do not touch the electric cable until the electrical supply has been disconnected. Do not repair a cut or damaged cable. Replace it with a new one.
5. Your extension cable must be uncoiled, coiled cables can overheat and reduce the efficiency of your product.
6. Do not pull cable around sharp objects.
7. Always switch off at the mains before disconnecting any plug, cable connector or extension cable.
8. Switch off before removing or fitting the collection box.
9. Switch off, remove plug from mains and examine electric supply cable for damage or ageing **before** winding cable for storage. Do not repair a damaged cable, replace it with a new one. Use only Flymo replacement cable.
10. Always wind cable carefully, avoiding kinking.
11. Never pull on the cable to disconnect any of the plugs.
12. Use only on AC mains supply voltage shown on the product rating label.

Preparation

1. Always wear suitable clothing, gloves, and stout shoes. Avoid wearing loose-fitting clothing or that has hanging cords or ties.
2. Obtain and wear safety glasses at all times.
3. Before using the machine check that all screws, nuts, bolts and other fasteners are properly secured and guards and screens in place and in good working condition.
4. Replace damaged or unreadable warning and operating labels.
5. Before starting the product, make certain that the feed inlet is empty.
6. Do not operate the product in the vicinity of bystanders.

Use

1. Use the product only in daylight or good artificial light.
2. Operate the product only on a firm, level surface.
3. Do not allow hands or any other part of the body or clothing inside the feed inlet or near any moving part.
4. Keep face and body away from the feed inlet opening.
5. Keep a proper balance and footing at all times. Do not overreach. Never stand at a higher level than the base of the product when feeding material into it.
6. When feeding material into the product be extremely careful that pieces of metal, rocks, bottles, cans, ropes, netting or other foreign objects are not included.
7. When feeding material into the product be extremely careful that the mains cable is not accidentally fed into the product.
8. Keep hands and feet away from the cutting means at all times and especially when switching on the motor.
9. Do not touch the cutting means before the machine is disconnected from the supply and the cutting means have come to a complete stop.
10. Do not tilt product when the power source is running.
11. Do not fold product when the power source is running.
12. When folding the product for storage please ensure the mains cable is kept clear.
13. Whilst using the product ensure the cable does not become trapped under the wheels or support feet.
14. Do not allow processed material to build up in the discharge area. This may prevent proper discharge and can result in kickback of material through the feed opening.
15. Use only Approved Replacement Parts.
16. Remove the plug from the mains :
 - before leaving the product unattended for any period or when transporting;
 - before clearing a blockage;
 - before checking, cleaning or working on the product;
 - if the product starts to vibrate abnormally or makes an unusual noise. Check immediately. Excessive vibration can cause injury.

Maintenance and storage

1. Keep all nuts, bolts and screws tight to be sure the product is in safe working condition. Do not attempt to repair the product unless you are competent to do so.
2. Check the collection box frequently for wear or deterioration.
3. Replace worn or damaged parts for safety.
4. Only use the replacement parts specified for this product.
5. Be careful during folding of the product to prevent entrapment of the fingers between moving and fixed parts of the machine.

Cable Information

IMPORTANT

• Use only 1.5mm² size cable up to 25 metres length maximum.

Maximum rating :

1. 5mm² size cable, 16 amps 250 volts AC.

• YOUR PRODUCT IS SUPPLIED WITH CABLE WIRED DIRECTLY INTO THE PRODUCT.

1. Do not wire an extension cable directly to your product yourself. Please contact your local Approved Service Centre for further information on the connectors and kits available.
2. Only use extension cables specifically designed for outdoor use.
3. Only use 1.5mm² 3 core extension cable.

MAINS PLUG REPLACEMENT

• **If the plug supplied is cut off it should be destroyed.**

There is an electric shock hazard if a cut off plug is inserted into a 13 amp socket.

1. **Ensure the mains voltage suits your product**
2. **IMPORTANT!** The wires in the mains lead are coloured in accordance with the following code:

BLUE - NEUTRAL BROWN - LIVE GREEN/YELLOW - EARTH

The wire which is coloured BLUE must be connected to the Terminal which is marked with the letter 'N' or coloured BLACK. The wire which is coloured BROWN must be connected to the Terminal which is marked with the letter 'L' or coloured RED. The wire which is coloured GREEN/YELLOW must be connected to the Terminal which is marked with the 'earth' symbol.

4. It is important that the outer sheath is clamped correctly into the 3-pin plug.
5. If in doubt consult your local Service Repairer or qualified electrician before the machine is used.
6. **A 13 Amp fuse must be fitted to the Mains Plug.**
7. The normal plug fuse and household fuse only protect the electrical equipment and are not a safeguard against electrocution.

Assembly

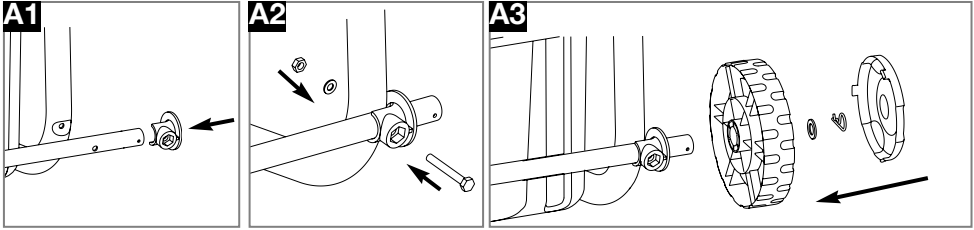

1. Push axle holder onto one end of the axle until the hole in the axle holder and the hole in the axle are aligned (**A1**). Repeat on the other side.
2. Using the spanner provided, attach the axle to the product with the axle bolt, washer and nut as illustrated in **pic. A2**. Repeat on the other side.
3. Attach the wheel and washer onto the axle (**A3**) ensuring the wheel is secured with the retaining pin (**A4**). Attach the hub cap, ensuring the clips and holes are aligned before securing into place. Repeat on the other side.

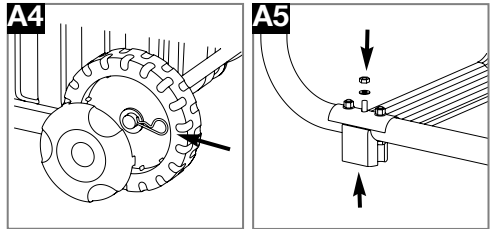

4. Using the spanner provided, attach the support foot with the support foot bolt, washer and nut as illustrated in **pic. A5**. Repeat on the other side.
5. Attach the cable hook to the product as illustrated in **pic A6**. Repeat for the other three cable hooks. This enables the mains cable to be wrapped around the product for storage and transportation (**C**).

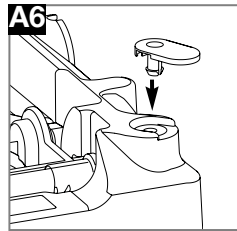

Preparation

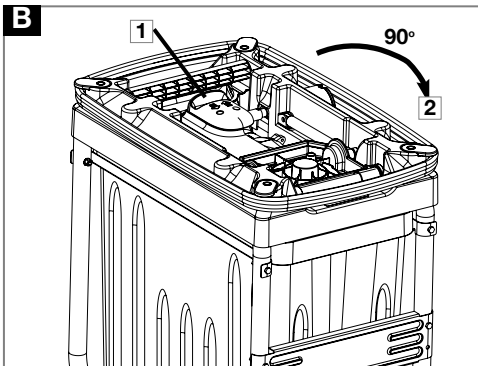

1. Unfold the product by sliding the catch (**B1**) and unfolding through 90° (**B2**) until it locks into the operating position.
2. The product can be transported to the required location by holding the transport handle (**C1**) and tilting it onto the wheels, as illustrated in **pic C**.
3. Before operating the product, ensure the collection box is correctly located and the Interlock Switch (**D1**) is securely in place. The product will not start if the Interlock Switch is not located correctly.

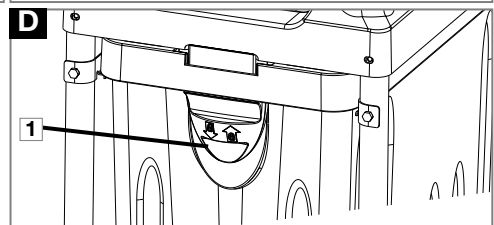
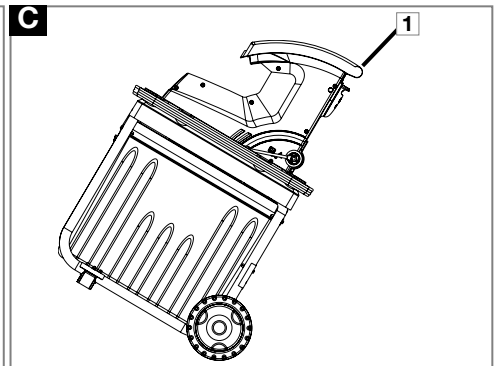

Starting and Stopping

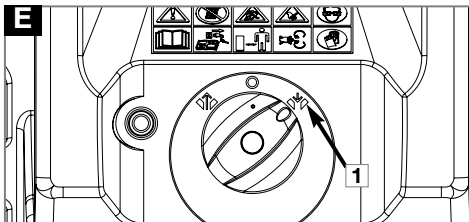

- Before starting, ensure that the Feed Inlet is empty

Starting

1. Unwind mains cable from around product and connect to mains supply.
2. To start the product, turn the control switch clockwise to the symbol (E1).

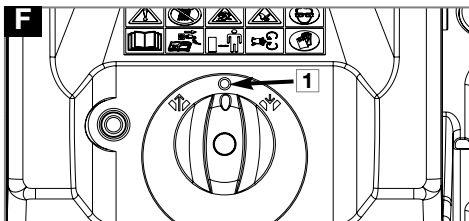

Stopping

1. To stop the product, turn the control switch anti-clockwise back to the O symbol (F1).

Use

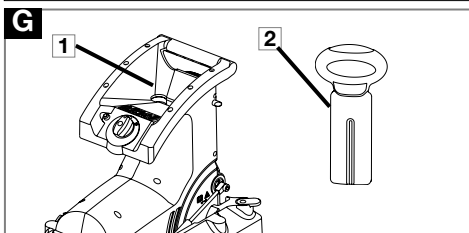

Feeding in Garden waste

1. Feed the material to be shredded into the Feed Inlet (G1). The material is pulled in by the cutting blade automatically.
- **Caution! Do not feed garden building waste such as, sawn timber, fencing and decking.**
 - **Caution! Long material standing out from the machine could swing out when being pulled in by the blades!. Maintain a safe distance!**

Suitable Items to be shredded:-

- Twigs and branches – max. diameter 40mm;
 - Waste from pruning bushes;
 - Waste from hedge trimmings
 - Plant parts.
2. A push stick is provided to feeding less bulky material into the Feed Inlet (G2) enabling the material to reach the cutting blade.
- **Do not use any other object to push material into the Feed Inlet.**

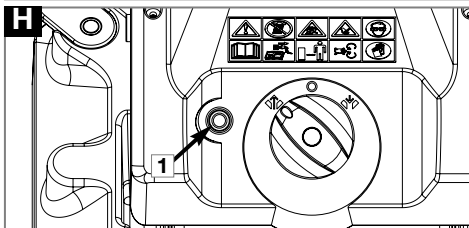

Overload Reset Button

- Overloading, jamming the product causes the machine to automatically stop. After a short period of time, press the reset button (H1) and restart the product.**
- **When the feed inlet is suddenly blocked, the direction or rotation may switch automatically. Stop the product and after a short period of time, restart.**

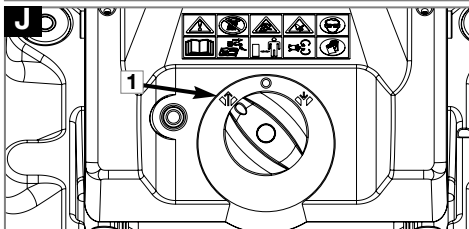

Clearing a Blockage

The product is fitted with a reverse switch (J1) to enable the release of jammed material. Turn the control switch anti-clockwise to the symbol to put into reverse mode.

How does my Shredder help composting?

Shredders can produce large quantities of Greens and Browns, which you could not normally compost. It will speed up the composting process by reducing the size and increasing the surface area of the material.

Shredded Browns, fibrous materials, provide body to the final product and supply trapped air to the composting creatures.

Shredded Greens, Soft Sappy materials, provide the energy for the composting creatures.

Compost

Compost is a natural fertiliser. It can loosen clay soils and can help sandy soils retain water. The organic matter in compost provides food for the microorganisms that keep your soil healthy and in a balanced condition. These microorganisms will naturally produce the Nitrogen, Potassium and Phosphorus your garden requires. The waste you are composting requires the correct ratio of carbon rich materials (Browns) and nitrogen rich materials (Greens). Too much Brown material will increase the conversion time. Too much Green material and your compost will be damp, solid and release unpleasant odours.

Use cont'

Garden Waste	Do Compost	Other
Tree Prunings*	Kitchen Waste	Washed Seaweed
Twigs*	Fruit	Hay/Straw
Plants*	Vegetables	Paper & Cardboard
Bush Prunings*	Teabags	Wood Ash
Hedge Trimmings*	Coffee Grounds & Filters	Manure from Vegetarian Animals
Vegetable Waste*	Egg Shells	
Leaves*	Sawdust	
Flowers*	Peanut Shells	
Roots*		
Grass Cuttings		

* Suitable for Shredding

Garden Waste	Do Not Compost	Other
Soil	Kitchen Waste	Vacuum Cleaner Contents
Poison Ivy	Meat	Plastic Glass or Metal
Poison Oak	Fish	Manure from Carnivorous Animals
Weeds	Cooked Food Wastes	Coal Ash
Diseased Plants	Dairy Products	Household or Building Waste
	High Fat Foods	

When will the compost be ready for use?

The compost may be ready in as little as 2 months or as much as 12 months. It depends on the materials used, the compost mix, air

temperature and how much material was shredded.

The compost can be used when it has turned a dark colour and the original ingredients are no longer recognisable.

Collection Box

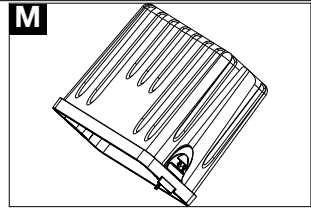
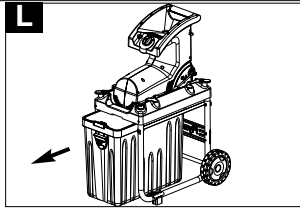
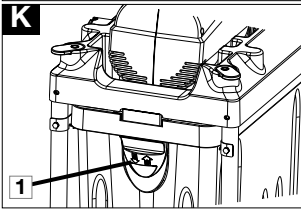

• Important

Switch off product before removing the Collection Box.

The Collection Box is a safety guard that prevents access to the cutting blades. The product should never be used without the Collection Box in place.

Removing the Collection Box

1. Pull down the Interlock Switch on the Collection Box (K1). The product will not operate when this Interlock Switch is open.

2. Hold the handle on the Collection Box and pull out from under the shredding unit (L).

3. Empty the Collection Box (M).

Fitting the Collection Box

1. Push the Collection Box under the shredding unit.
2. Push up the Interlock Switch on the Collection Box (K1) until it clicks securely into position.

- **IMPORTANT ! The Product will not operate if the Interlock Switch on the Collection Box is not lifted upwards into position.**

Adjustment

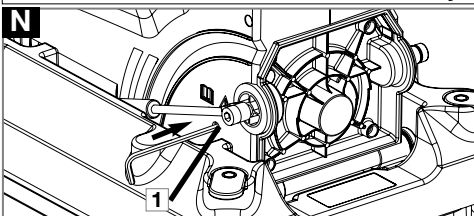

- **Important:- Only adjust the Cutting Plate when the product is running. Failure to do so may lead to serious damage to your product and result in your Warranty becoming void.**

Adjusting the Cutting Plate

If branches and twigs are not being cut through cleanly, then adjustment of the Cutting Plate against the Cutting Blade is required.

1. With the product running in the forward direction insert the hex key supplied into the hole at the side

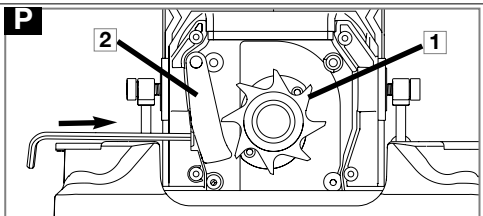

- of the casing (N1).
2. With the product running in the forward direction turn the hex key very slowly in a clockwise direction until the Cutting Blade (P1) can be heard slightly touching the Cutting Plate (P2). **Do not over adjust, doing so could cause serious damage to the Cutting Plate and Cutting Blade and result in your Warranty becoming void.**
3. Feed a branch into the Feed Inlet to check that it is cut cleanly and that no further adjustment is required.

Caring for your Shredder

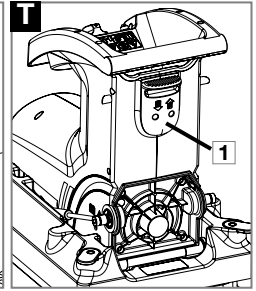
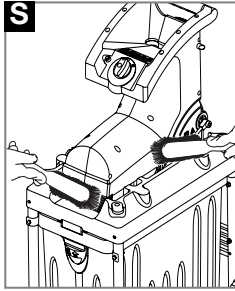
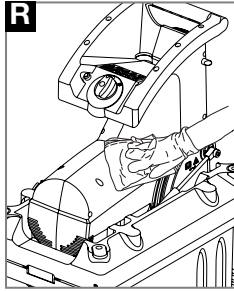
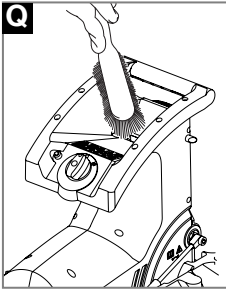

Cleaning

• USE GLOVES

• **IMPORTANT** It is very important that you keep your product clean. Debris left in any of the air intakes or under the product could become a potential fire hazard.

1. With a brush, remove any debris from the Feed Inlet (Q)
2. Wipe over the surface of your product with a dry cloth (R).
3. Using a soft brush remove debris from all air intakes (S).
4. Remove the Collection Box as described in the Collection Box section above.
5. Fold the product by sliding the catch (T) and folding through 90° (V) until it locks into the storage position.
6. Remove debris from the discharge area with brush (W).
7. Remove debris from the grass box with a brush (X).

• **IMPORTANT** Never use water for cleaning your product. Do not clean with chemicals, including petrol, or solvents - some can destroy critical plastic parts.

Storing your Shredder

1. Unfold your product back into the operating position, replace the collection box and then fold into the storage position.
2. Before folding make sure that the electric cable is wound around the product properly (Y1).
3. Replace any Bolts, Nuts or Screws, if necessary.
4. Product must be stored upright as illustrated (Y1)

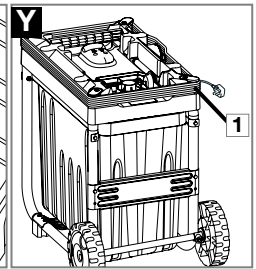
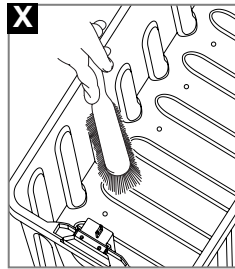
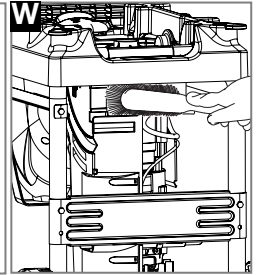
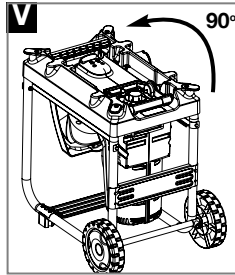

Fault Finding Hints

Fails to Operate

1. Is the correct Starting procedure being followed? See 'Starting & Stopping'
2. Has the product overloaded? See 'Use'
3. Is the Power Turned On?
4. Is the Interlock Switch engaged?. See 'Collection Box'
5. Check the fuse in the plug, if blown replace.
6. Fuse continues to blow?

Immediately disconnect from the mains electricity supply and consult your local approved Service Centre.

Debris Material is not pulled into the cutter.

1. By using the Push Stick, ensure the material is fed far enough into the Feed Inlet
2. Ensure the Cutter is adjusted correctly, see 'Adjustment'
3. Is the product running in the forward direction.?
4. If problem persists?

Immediately disconnect from the mains electricity supply and consult your local approved Service Centre.

Poor Cutting of Debris Material

1. See 'Adjustment'
2. If poor cutting persists.

Immediately disconnect from the mains electricity supply and consult your local approved Service Centre.

Debris Material is jammed in the Feed Inlet

1. Set the start switch to reverse.
2. Ensure the material is not too thick for the product. Max diameter of twigs and branches is 40mm.
3. If problem persists?

Immediately disconnect from the mains electricity supply and consult your local approved Service Centre.

Excessive Vibration

1. Disconnect from the mains electricity supply.
2. Ensure the Cutter is adjusted correctly, see 'Adjusting the Cutting Plate'
3. If vibration persists?

Immediately disconnect from the mains electricity supply and consult your local approved Service Centre.

Service Recommendations

1. We strongly recommend that your product is serviced at least every twelve months, more often in a professional application.
2. Always use genuine Flymo Spare Parts.
3. Prepacked spares are available from most Husqvarna Outdoor Products stockists.
4. Your product is uniquely identified by a silver and black product rating label.
5. If you have a problem with your machine contact your local Approved Service Centre ensuring you have full details of your product as described on the product rating label.
6. **Should it be necessary for work to be carried out by your**

Service Centre, it is important to take your complete machine including cable and any extension cables used.

A network of specialist dealers can be found in your local Yellow Pages. To obtain service on your Flymo product simply telephone or visit your local Service Centre. Should you require service under the terms of our guarantee the Service Centre will require proof of purchase.

All of the centres listed stock genuine Flymo Spare Parts.

NOTE: Our Service Repairs act on their own behalf and are not empowered to commit or legally bind Husqvarna Outdoor Products in any manner whatsoever.

Environmental Information

- Awareness of the environment must be considered when disposing of 'end-of-life' product.
- If necessary, contact your local authority for disposal information.



The symbol on the product or on its packaging indicates that this product may not be treated as household waste. Instead it shall be handed over to the applicable collection point for the recycling of electrical and electronic equipment.

By ensuring this product is disposed of correctly, you will help prevent potential negative consequences for the environment and human health, which could otherwise be caused by inappropriate waste handling of this product.

For more detailed information about recycling of this product, please contact your local council office, your household waste disposal service or the shop where you purchased the product.

Guarantee & Guarantee Policy

If any part is found to be defective due to faulty manufacture within the guarantee period, Husqvarna Outdoor Products, through its Authorised Service Repairers will effect the repair or replacement to the customer free of charge providing:

- (a) The fault is reported directly to the Authorised Repairer.
- (b) Proof of purchase is provided.
- (c) The fault is not caused by misuse, neglect or faulty adjustment by the user.
- (d) The failure has not occurred through fair wear and tear.
- (e) The machine has not been serviced or repaired, taken apart or tampered with by any person not authorised by Husqvarna Outdoor Products.
- (f) The machine has not been used for hire.
- (g) The machine is owned by the original purchaser.
- (h) The machine has not been used commercially.

* This guarantee is additional to, and in no way diminishes the customers statutory rights.

Failures due to the following are not covered, therefore it is important that you read the instructions contained in this Operator's Manual and understand how to operate and maintain your machine:

Failures not covered by guarantee

- Replacing worn or damaged blades
- Failures as a result of shredding inappropriate material.
- Failures as a result of incorrect adjustment of the cutting plate
- Failures as a result of not reporting an initial fault.
- Failures as a result of sudden impact.
- Failures as a result of not using the product in accordance with the instructions and recommendations contained in this Operator's Manual.
- Machines used for hire are not covered by this guarantee.
- The following items listed are considered as wearing parts and their life is dependent on regular maintenance and are, therefore not normally subject to a valid warranty claim:
 - Blades, Electric Mains cable, Cutting Plate
- **Caution!** Husqvarna Outdoor Products does not accept liability under the warranty for defects caused in whole or part, directly or indirectly by the fitting of replacement parts or additional parts that are not either manufactured or approved by Husqvarna Outdoor Products, or by the machine having been modified in any way.

EC Declaration of Conformity

I, the undersigned M. Bowden of Husqvarna Outdoor Products, Aycliffe Industrial Park, NEWTON AYCLIFFE , Co. Durham. DL5 6UP. Certify that the product:- Category..... Electric Quiet Shredder Make..... Husqvarna Outdoor Products Conforms to the specifications of Directive 2000/14/EC	I, the undersigned M. Bowden of Husqvarna Outdoor Products, Aycliffe Industrial Park, NEWTON AYCLIFFE , Co. Durham. DL5 6UP. Certify the maximum weighted sound pressure level recorded on a sample of the above product at the operator position under free field conditions was: -	I, the undersigned M. Bowden of Husqvarna Outdoor Products, Aycliffe Industrial Park, NEWTON AYCLIFFE , Co. Durham. DL5 6UP. Certify the maximum weighted root mean square value recorded on a sample of the above product at the operators hand position was: -
Type of Cutting Device..... Rotating Blades Identification of Series..... See Product Rating Label Conformity Assessment Procedure..... ANNEX VI Notified Body..... Intertek., Cleeve Road, Leatherhead, Surrey. KT22 7SB England	Other Directives:-..... 98/37/EEC, 89/336/EEC, 73/23/EEC & applicable standards:- EN61000-3-2, EN61000-3-3, EN55014-1, EN55014-2, EN50366, EN60335-1, prEN60335-2-93, EN13683, prEN50434	Type..... PAS-2500 Width of Cut..... 40 mm Speed of Rotation of Cutting Device..... 40 RPM Guaranteed sound power level..... 96 dB (A) Measured Sound Power Level..... 95 dB (A) Level..... 85 dB (A) Value..... 2.40 m/s² Weight..... 33.5 kg

Newton Aycliffe, 21/11/2006
 M. Bowden,
 Research & Development Director

Husqvarna Outdoor Products
 Aycliffe Industrial Park
 NEWTON AYCLIFFE
 Co.Durham DL5 6UP
 ENGLAND

Telephone - 0870 609 1901 Fax - 0870 609 1902

Our policy of continuous improvement means that the specification of products may be altered from time to time without prior notice.

