

Flymo

 Electrolux

GARDENVAC
Plus

GARDENVAC
Turbo

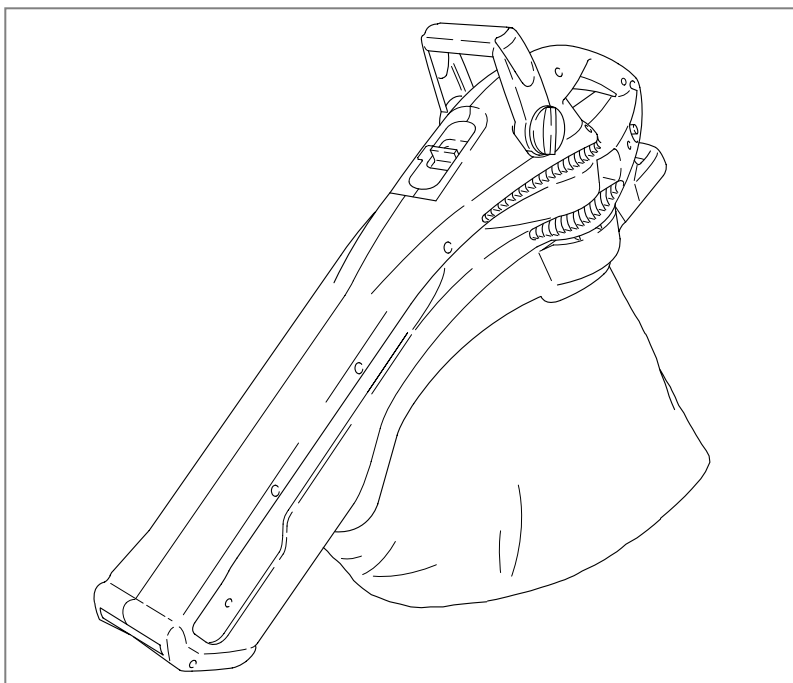

IMPORTANT INFORMATION
Read before use
& retain for future reference



Carton Contents

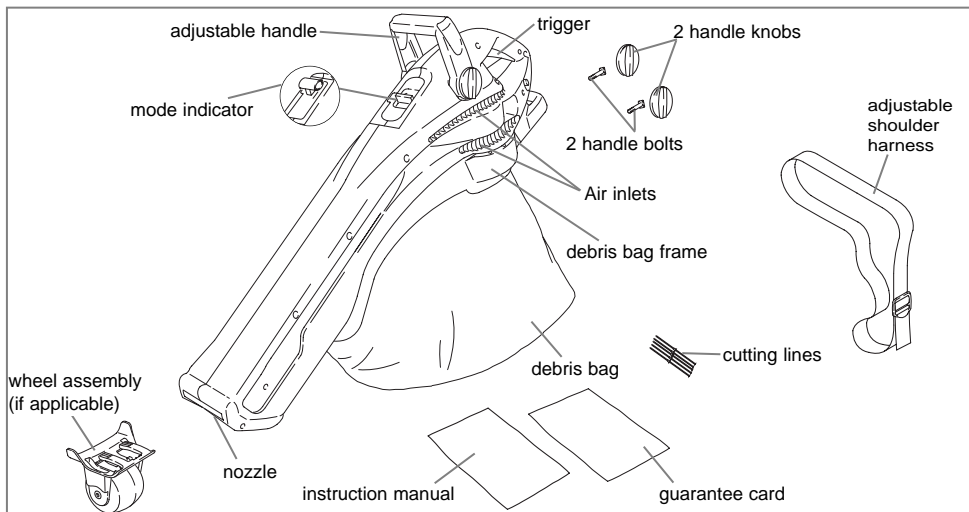

IMPORTANT ! Please check the contents of the carton are correct **BEFORE** assembling your new Flymo product.
IF ANY PARTS ARE MISSING CONTACT:- Electrolux Outdoor Products Customer Service Department direct
 Telephone : 01325 300303, Fax : 01325 318193

Safety



If not used properly this Gardenvac can be dangerous.

The warnings and safety instructions must be followed to ensure reasonable safety and efficiency in using this product. The operator is responsible for following the warnings and instructions in this manual and on the product.

Explanation of Symbols on the Gardenvac



Warning



Read the user instructions carefully to make sure you understand all the controls and what they do.



Do not operate in the rain or leave the Gardenvac outdoors while raining.

BEFORE USING YOUR GARDENVAC FOR THE FIRST TIME



Assemble debris bag to bag frame.

EVERY TIME YOU USE YOUR GARDENVAC



Switch off and disconnect from the mains electricity supply **BEFORE** fitting cutting line to cutting head & clipping into place and **BEFORE REMOVING** cutting line.



Switch off and disconnect from the mains electricity supply **BEFORE FITTING** fully assembled debris bag to product and **BEFORE REMOVING** fully assembled debris bag from product.
NEVER CONNECT THE PRODUCT TO THE MAINS ELECTRICITY SUPPLY UNTIL THE FULLY ASSEMBLED DEBRIS BAG IS FITTED CORRECTLY

General

1. Never allow children or people unfamiliar with these instructions to use the product. Local regulations may restrict the age of the operator.
2. Only use the product in the manner and for the functions described in these instructions.
3. Never operate the product when you are tired, ill or under the influence of alcohol, drugs or medicine.
4. The operator or user is responsible for accidents or hazards occurring to other people or their property.

Electrical

1. The British Standards Institute recommend the use of a Residual Current Device (R.C.D.) with a tripping current of not more than 30mA. Even with a R.C.D. installed 100% safety cannot be guaranteed and safe working practice must be followed at all times. Check your R.C.D. every time you use it.
2. Before use, examine cable for damage, replace it if there are signs of damage or ageing.

3. Do not use the product if the electric cables are damaged or worn.
4. Immediately disconnect from the mains electricity supply if the cable is cut, or the insulation is damaged. Do not touch the electric cable until the electrical supply has been disconnected. Do not repair a cut or damaged cable. Replace it with a new one.
5. Your electric cable must be uncoiled, coiled cables can overheat and reduce the efficiency of the product.
6. Do not pull cable around sharp objects.
7. Always switch off at the mains before disconnecting any plug, cable connector or extension cable.
8. Switch off, remove plug from mains and examine electric supply cable for damage or ageing **before** winding cable for storage. Do not repair a damaged cable, replace it with a new one. Use only genuine replacement cable.
9. Never carry the product by the cable.
10. Never pull on the cable to disconnect any of the plugs
11. Always wind cable carefully, avoiding kinking.
12. Use only on AC mains supply voltage shown on the product rating label.
13. Our products are double insulated to EN60335. Under no circumstance should an earth be connected to any part of the product.

Preparation

1. Always wear suitable clothing, gloves, and stout shoes.
2. The use of eye protection is recommended.
3. The use of ear protection is recommended.
4. To prevent dust irritation, the wearing of a face mask is recommended.
5. Do not wear loose clothing or jewellery that can be drawn into the air inlet.
6. Do not wear clothing with attachments, i.e. toggles or drawstrings that can be drawn into the air inlet.
7. Inspect your product before each use, especially the parts of the cutting head. Replace cutting line if worn or damaged.
8. Do not use if any part is damaged or broken or if any of the screws are loose. Have it repaired by an authorised repairer.

CABLES IMPORTANT

- Use only 1.00mm² size cable up to 30 metres length maximum.

Maximum rating :

- 1.00mm² size cable, 10 amps 250 volts AC.

• THE GARDENVAC IS SUPPLIED WITH CABLE WIRED DIRECTLY INTO THE PRODUCT.

1. Flymo Mains Cables and Extension Cables are available from your local Electrolux Outdoor Products Approved Service Centre.
2. Do not wire an extension cable directly to your product yourself. Please contact your local Electrolux Outdoor Products Approved Service Centre for further information on the connectors and kits available.
3. Only use extension cables specifically designed for outdoor use.

CONNECTORS IMPORTANT

- Flymo connectors are suitable for use with 2 core cable only. Under no circumstances should these connectors be used for earthed products.
- All Flymo connectors and cables are of splashproof construction. They are not waterproof and must not be left outside permanently nor should they be submerged or immersed in water. Do not let cable lay or trail through pools of water or splashed with water from hose pipes.

MAINS PLUG REPLACEMENT IMPORTANT

- If the plug supplied is cut off it should be

9. Always check your product is in a safe operating condition before use.

Use

1. Use the product only in daylight or good artificial light.
2. Do not use the product when it is raining or in damp and wet areas.
3. Never use the product in or near water or ponds.
4. Know how to stop the product quickly in an emergency.
5. On slopes, be extra careful of your footing and wear non-slip footwear.
6. Never pick up or carry the product by the cable.
7. Keep children, pets and bystanders at a safe distance when using your product.
8. Keep long hair away from air inlet.
9. Keep all inlets clear of debris.
10. Always remain alert.
11. Do not attempt to use your product without the fully assembled debris bag fitted.
12. Never blow debris in the direction of bystanders.
13. Do not overreach. Keep proper footing and balance at all times.
14. The cutting head and cutting line continue to rotate after your product has been switched off.
15. Remove the plug from the mains :-
 - before removing or replacing cutting line;
 - before removing or replacing fully assembled debris bag;
 - before leaving the product unattended for any period;
 - before clearing a blockage;
 - before checking, cleaning or working on the appliance;
 - if the product starts to vibrate abnormally. Check immediately. Excessive vibration can cause injury.

Maintenance and storage

1. Keep all nuts, bolts and screws tight to be sure the product is in a safe working condition.
2. Replace worn or damaged parts for safety.
3. After use the product should be stored in a safe place where it is protected from damage.
4. Inspect the collection bag regularly. If the collection bag becomes worn or damaged, replace.

destroyed. There is an electric shock hazard if a cut off plug is inserted into a 13 amp socket.

1. **No earth required.** Flymo products are double insulated to EN60335 and under no circumstances should an earth be connected to any part of the product.
2. **Ensure the mains voltage suits your product**
3. **IMPORTANT!**
The wires in the mains lead are coloured in accordance with the following code:
BLUE - NEUTRAL
BROWN - LIVE
The wire which is coloured BLUE must be connected to the Terminal which is marked with the letter 'N' or coloured BLACK.
The wire which is coloured BROWN must be connected to the Terminal which is marked with the letter 'L' or coloured RED.
4. It is important that the outer sheath is clamped correctly into the 3-pin plug.
5. If in doubt consult your local Service Repairer or qualified electrician before the machine is used.
6. **A 13 Amp fuse must be fitted to the Mains Plug.**
7. The normal plug fuse and household fuse only protect the electrical equipment and are not a safeguard against electrocution.

If your product is hard wired i.e. non-detachable mains electric cable, a conversion kit and extension cable is available from all Electrolux Outdoor Products Approved Service Centres which can be found in your local Yellow Pages.

Assembly Instructions

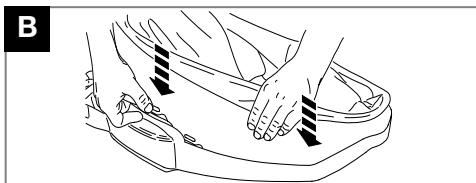
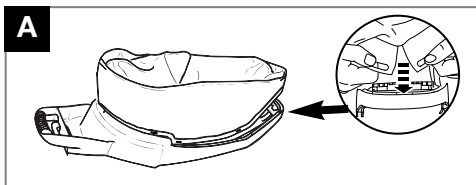

To Attach Debris Bag to Bag Frame With bag frame on the ground:-

1. Fit first two holes on the plastic trim of the debris bag to the first two location points on the front of the bag frame (where debris fin is attached). **(A)**
 2. Fit next hole on the plastic trim to next location point on bag frame. **(B)**
 3. ...until all holes on the plastic trim of the debris bag are securely located to bag frame. **(C)**
- **ENSURE THE DEBRIS BAG IS FITTED SECURELY TO THE BAG FRAME.**

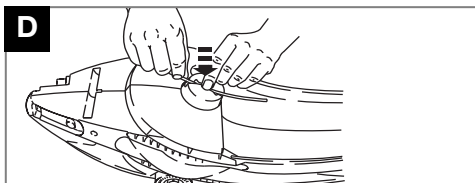
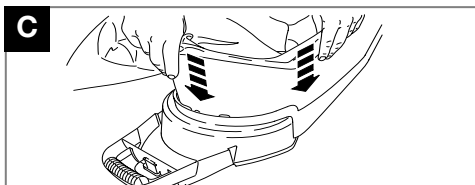

To Fit the Cutting Line to the Cutting Head (D)

- **Switch off and disconnect from the mains electricity supply BEFORE removing or fitting the cutting line.**
 - **Handle the cutting line with care - sharp edges can cause injury.**
1. Place the cutting line into the slot in the cutting head and click into place as illustrated in **Figure D**.
 - **Ensure the cutting line is correctly located.**
 - **ONLY USE CUTTING LINE SPECIFIED FOR THIS PRODUCT. SEE PRODUCT RATING LABEL FOR MODEL DETAILS**

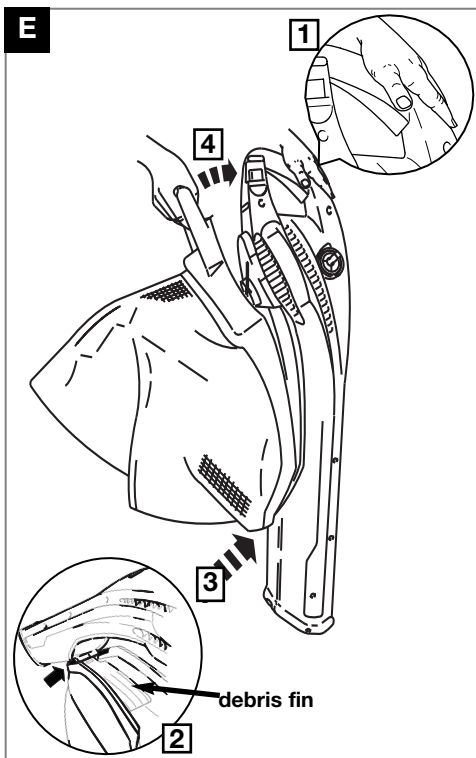

To Fit Assembled Debris Bag To Product (E)

- **Switch off and disconnect from the mains electricity supply BEFORE REMOVING OR REPLACING the fully assembled debris bag.**
- **The cutting head and cutting line continue to rotate after your Gardenvac has been switched off.**

IMPORTANT: Do not squeeze the trigger when fitting the debris bag (E1)

1. Ensure debris fin is horizontal **(E2)** as illustrated in **fig E**.
2. Locate bag frame into clip on the underside of product. **(E3)**
3. Lift handle towards product until bag latch locates and click into place. **(E4)**

To Remove Debris Bag From Product (F)

1. Gently press bag latch **(F1)** down. **See fig F**.
2. Lower handle of bag frame away from product.
3. Move bag frame forward.

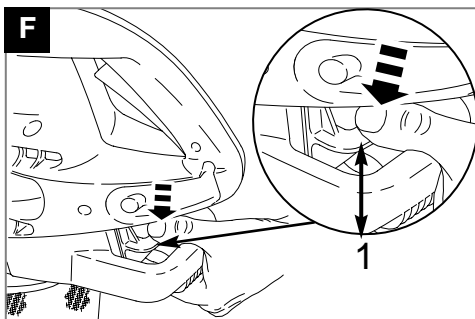

Assembly instructions

Fitting the Handle Bolt (G)

1. Place handle bolt into the location slot on the product and slide into place. **(G)**.
2. Repeat on the other side.

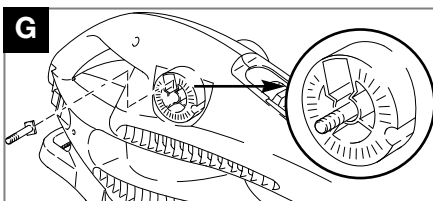

Fitting the Handle (H)

1. Locate handle onto handle bolts on each side of the product.
2. Secure handle by turning handle knobs clockwise. **(H)**
3. The handle can be adjusted by turning handle knobs 3 full turns anti-clockwise, moving handle to position required and re-securing handle as described in 2.

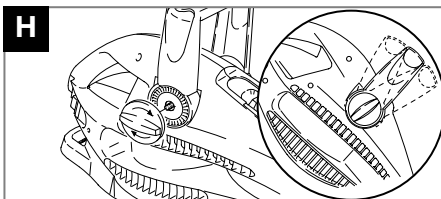

Fitting The Shoulder Harness (J) & (K).

1. Thread strap through the slots in the handle. **(J)**
2. Thread strap through the buckle. **See fig J.** Adjust as required to ensure the shoulder harness is in the most comfortable position. **See fig. K.**

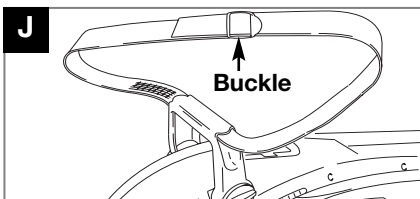

How to attach wheel (if applicable)

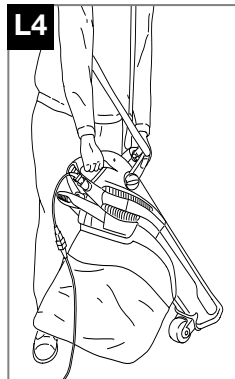
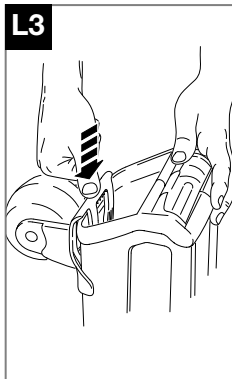
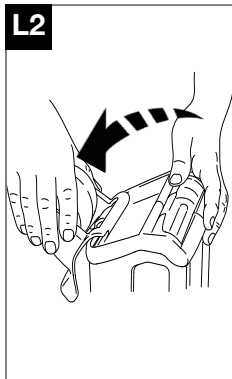
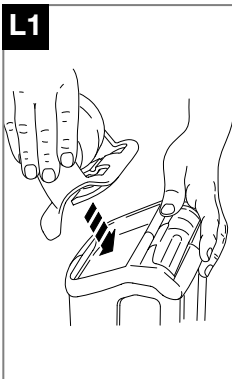

How to Use

WARNING

The use of eye protection is recommended. The use of ear protection is recommended.

To prevent dust irritation, the wearing of a face-mask is recommended. Never point your product at bystanders. Do not use your product in the rain. Do not leave your product outdoors while it is raining.

IMPORTANT!: YOUR PRODUCT WILL NOT OPERATE UNTIL THE FULLY ASSEMBLED DEBRIS BAG AND FRAME ARE PROPERLY FITTED.

BEFORE USE: ENSURE THERE ARE NO GAPS BETWEEN THE DEBRIS BAG AND THE PRODUCT.

- The Gardenvac has 3 modes of operation.
- These can be selected by moving the mode indicator to adjust the nozzle position for blow, vacuum or jet vacuum mode.
- In vacuum and jet vacuum modes the product will shred leaves etc.

BLOW

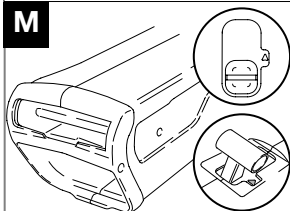
M

Position 1 - Blow Mode

The Gardenvac will blow debris from patios, paths, driveways, lawns, bushes, borders etc.

Using As A Blower

1. Select position 1 on the mode indicator. **See fig M.**
2. Point nozzle towards the ground.
3. To start squeeze trigger.
4. Stand back from debris to be cleared.
5. Point nozzle towards the debris and slowly approach.
6. To stop release trigger.

VACUUM

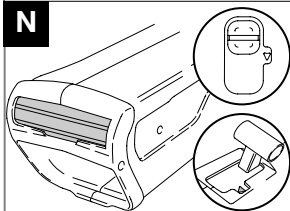
N

Position 2 - Vacuum Mode

In this position your product will pick up leaves, paper, rubbish, cans etc. **IMPORTANT: REMOVE NYLON LINE BEFORE VACUUMING CANS**

Using As A Vacuum

1. Select position 2 on the mode indicator. **See fig N.**
2. Position nozzle slightly above the debris, squeeze the trigger and move slowly back and forth.
3. Do not force the nozzle into the debris as this will impair performance.
4. To stop release the trigger.

JET VACUUM

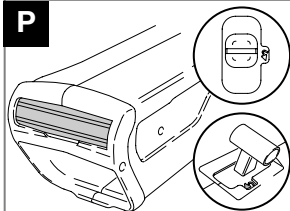
P

Position 3 - Jet Vacuum Mode

This position is intended to be used to collect debris which is damp or stubborn. It directs a small jet of air towards the ground which will loosen stubborn material.

Using As A Jet Vacuum

1. Select position 3 on the mode indicator. **See fig P.**
2. Position the nozzle above and slightly forward of the debris and squeeze the trigger.
3. Slowly move the nozzle back over the debris. This allows a jet of air to lift the debris from the ground.
4. To stop release the trigger.

Emptying your Gardenvac

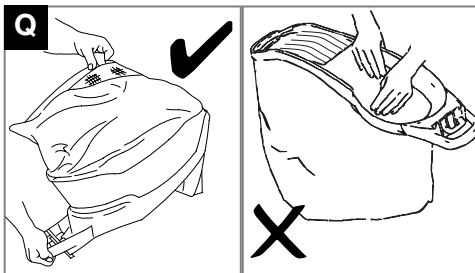
Q

- Switch off and disconnect from the mains electricity supply **BEFORE REMOVING OR REPLACING** the fully assembled debris bag.

Emptying Your Gardenvac

1. Remove debris bag as described on **page 4**.
2. Empty debris bag holding the moulded handle at the top of the bag and the fabric handle at the bottom of the bag. **(Q)**
Do Not Place Hands In Bag When Emptying, Sharp Debris Can Cause Injury
3. Flip the debris fin back into place before re-fitting as described on **page 4**.

Caring for your Gardenvac

WARNING Never use water for cleaning your product, use only a dry cloth. Do not clean with chemicals or solvents, some can destroy critical plastic parts.

After Using Your Gardenvac (R1, 2, 3 & 4)

1. Switch off and disconnect from the mains electricity supply before cleaning your product.
2. Always empty the debris bag.
3. Take extra care to clean around the cutting head and the collection chute. **(R1)**
 - **Take care when cleaning around the cutting line area - sharp edges can cause injury.**
4. Inspect the cutting line and replace if worn or damaged
5. Using a soft brush remove debris from all air inlets. **(R2)**
6. Remove dirt and debris from debris fin with a suitable tool. **(R3)**
7. Wipe over your product with a soft dry cloth. **(R4)**

Replacing the Cutting Line (R5 & 6)

- **Switch off and disconnect from the mains electricity supply before replacing the cutting line**
- **Handle the cutting line with care - sharp edges can cause injury.**

1. Remove debris bag from product. **See Page 4.**
2. Remove cutting line **(R5)** and discard safely.
3. If the cutting line becomes broken during use - use a suitable tool to lever the line out of location. **(R6).**
4. Place the cutting line into the slot in the cutting head. Ensure the cutting line is correctly located. **See Page 3.**
5. Re-fit debris bag to product. **See Page 4.**

Storing Your Gardenvac

Always store the product in a dry place ensuring the cable is not likely to be damaged on sharp edges etc.

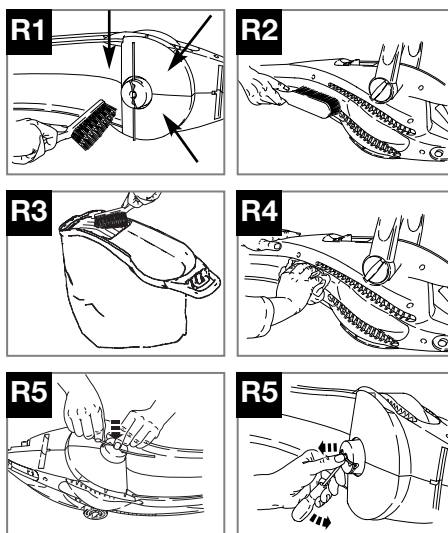

Fault Finding Hints

Fails To Operate

1. Is the power turned on?
2. Is the fully assembled debris bag correctly fitted to the product?
3. Check the fuse in the plug, if blown replace.
4. Fuse continues to blow?

Immediately disconnect from the mains electricity supply and consult your local Service Centre/Dealer/Distributor

Poor Blowing

1. The air inlets are blocked, clean all air inlets.
2. Mode indicator not in the right position?
3. If poor blowing persists?

Immediately disconnect from the mains electricity supply and consult your local Service Centre/Dealer/Distributor

Poor Vacuum/Jet Vacuum

1. The air inlets are blocked, clean all air inlets.
2. Mode indicator not in the right position?
3. If poor vacuuming persists?

Immediately disconnect from the mains electricity supply and consult your local Service Centre/Dealer/Distributor

Excessive Vibration

1. The cutting line is damaged - replace with new cutting line.
2. Ensure the fully assembled debris bag is correctly fitted to the product.
3. If excessive vibration persists?

Immediately disconnect from the mains electricity supply and consult your local Service Centre/Dealer/Distributor

Poor Shredding

1. The cutting line is damaged - replace with new cutting line.
2. **TO PROLONG CUTTING LINE LIFE**

The Gardenvac has been designed to shred leaves. If collecting large amounts of any other debris - remove the cutting line.

3. If poor shredding persists?

Immediately disconnect from the mains electricity supply and consult your local Service Centre/Dealer/Distributor

Service Recommendations

1. We strongly recommend that your product is serviced at least every twelve months, more often in a professional application.
2. Always use genuine Flymo Spare Parts.
3. Prepacked spares are available from most Electrolux Outdoor Products stockists.
4. Your product is uniquely identified by a silver and black product rating label
5. If you have a problem with your machine contact your local Approved Service Centre ensuring you have full details of your product as described on the product rating label.

6. **Should it be necessary for work to be carried out by your Service Centre, it is important to take your complete machine including cable and any extension cables used.**

A network of specialist dealers can be found in your local Yellow Pages. To obtain service on your Flymo product simply telephone or visit your local Service Centre. Should you require service under the terms of our guarantee the Service Centre will require proof of purchase.

All of the centres listed stock genuine Flymo Spare Parts.

NOTE: Our Service Repairers act on their own behalf and are not empowered to commit or legally bind Electrolux Outdoor Products in any manner whatsoever.

Environmental Information

Electrolux Outdoor Products are manufactured under an Environmental Management System (ISO 14001) using, where practical, components manufactured in the most environmentally responsible manner, according to company procedures, and with the potential for recycling at the end of the products' life.

- Packaging is recyclable and plastic components have been labelled (where practical) for categorised recycling.
- Awareness of the environment must be considered when disposing of 'end-of-life' product.
- If necessary, contact your local authority for disposal information.

Guarantee & Guarantee Policy

If any part is found to be defective due to faulty manufacture within two years of original purchase, Electrolux Outdoor Products, through its Authorised Service Repairers will effect the repair or replacement to the customer free of charge providing:

- (a) The fault is reported directly to the Authorised Repairer.
 - (b) Proof of purchase is provided.
 - (c) The fault is not caused by misuse, neglect or faulty adjustment by the user.
 - (d) The failure has not occurred through fair wear and tear.
 - (e) The machine has not been serviced or repaired, taken apart or tampered with by any person not authorised by Electrolux Outdoor Products.
 - (f) The machine has not been used for hire.
 - (g) The machine is owned by the original purchaser.
 - (h) The machine has not been used outside of the country for which it was specified.
 - (i) The machine has not been used commercially.
- * This guarantee is additional to, and in no way diminishes the customers statutory rights.

Failures due to the following are not covered, therefore it is important that you read the instructions contained in this Operator's Manual and understand how to operate and maintain your machine:

Failures not covered by guarantee

- * Replacing Nylon Line.
- * Failures as a result of not reporting an initial fault.
- * Failures as a result of sudden impact.
- * Failures as a result of not using the product in accordance with the instructions and recommendations contained in this Operator's Manual.
- * Machines used for hire are not covered by this guarantee.
- * The following items listed are considered as wearing parts and their life is dependent on regular maintenance and are, therefore not normally subject to a valid warranty claim: Cutting Line, Electric Mains cable, Debris Bag.
- * **Caution!**
Electrolux Outdoor Products does not accept liability under the warranty for defects caused in whole or part, directly or indirectly by the fitting of replacement parts or additional parts that are not either manufactured or approved by Electrolux Outdoor Products, or by the machine having been modified in any way

EC Declaration of Conformity

I, the undersigned M. Bowden of Electrolux Outdoor Products, Aycliffe Industrial Park, NEWTON AYCLIFFE , Co. Durham. DL5 6UP. Certify that the product:- Category..... Gardenvac Make..... Electrolux Outdoor Products Conforms to the specifications of Directive 2000/14/EEC		I, the undersigned M. Bowden of Electrolux Outdoor Products, Aycliffe Industrial Park, NEWTON AYCLIFFE , Co. Durham. DL5 6UP. Certify that a sample of the above product has been tested using directive 81/1051/EEC as a guide. The maximum A-weighted sound pressure level recorded at operator position under free field semi anechoic chamber conditions was :-		I, the undersigned M. Bowden of Electrolux Outdoor Products, Aycliffe Industrial Park, NEWTON AYCLIFFE , Co. Durham. DL5 6UP. Certify that a sample of the above product has been tested using ISO 5349 as a guide. The maximum weighted root mean square value of vibration recorded at operator's hand position was:-	
Identification of Series..... See Product Rating Label Conformity Assessment Procedure.... ANNEX VI Notified Body..... I.T.S., Cleeve Road, Leatherhead, Surrey. KT22 7SB England Other Directives:-..... 98/37/EEC, 89/336/EEC, 73/23/EEC & applicable standards:-. EN60555-2:1987, EN60555-3:1987, EN55014-1:1993, EN55014-2:1995, EN60335-1:1994		Type	MEV750/1600	MEV1500/1800/2200	
		Guaranteed sound power level	93 dB (A)	99 dB (A)	
		Measured Sound Power Level	91 dB (A)	99 dB (A)	
		Level	88.3 dB (A)	87.9 dB (A)	
		Value	6.99 m/s²	2.89 m/s²	
		Nominal Air Flow	0.0957 m³/s	0.1024 m³/s	
		Weight	4.5 kg	5.1 kg	



Newton Aycliffe, 30/05/02.
M. Bowden,
Research & Development Director

Electrolux Outdoor Products
Aycliffe Industrial Park
NEWTON AYCLIFFE
Co.Durham DL5 6UP
ENGLAND

Telephone - (00) 44 1325 300303 Fax - (00) 44 1325 310339
UK Customer Helpline - 01325 300303 Fax - 01325 310339

Our policy of continuous improvement means that the specification of products may be altered from time to time without prior notice. Electrolux Outdoor Products manufacture products for a number of well known brands under various registered patents, designs and trademarks in several countries.

© Electrolux Outdoor Products Ltd. Registered Office, Electrolux Works, Oakley Road, Luton LU4 9QQ
Registered number 974979 England



The Electrolux Group. The world's No. 1 choice.

The Electrolux Group is the world's largest producer of powered appliances for kitchen, cleaning and outdoor use. More than 55 million Electrolux Group products (such as refrigerators, cookers, washing machines, vacuum cleaners, chain saws and lawn mowers) are sold each year to a value of approx. USD 14 billion in more than 150 countries around the world.

